

## Installation Manual

<b>PART NUMBER(S)</b>	<b>Model Year</b>
<b>TESS 15162 SE</b>	<b>Toyota Hilux Revo GR 2025+</b>
<b>Cab(s)</b>	<b>Installation Time / Weight</b>
<b>Double Cab</b>	<b>40-60 minutes / 53-57 kg</b>

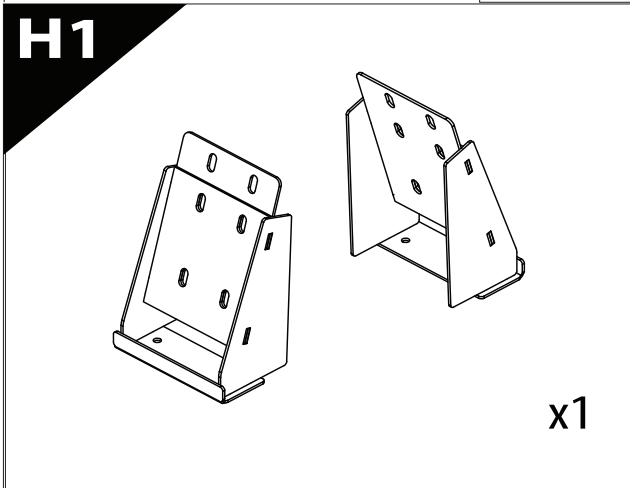

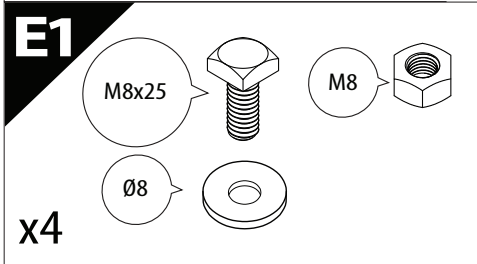
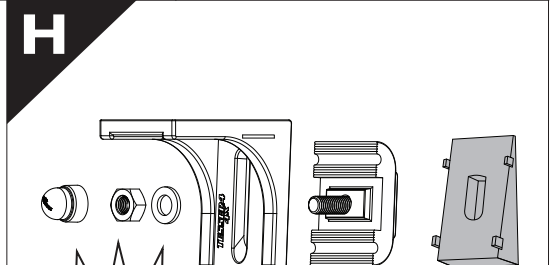
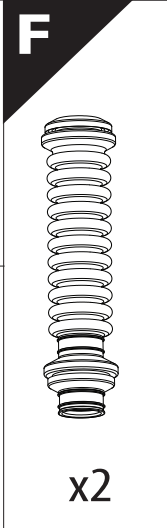
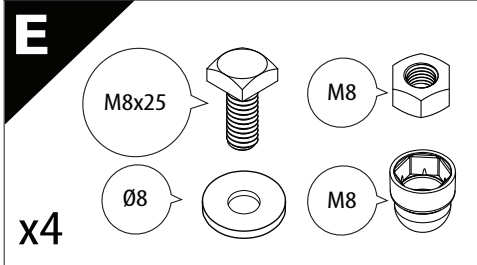
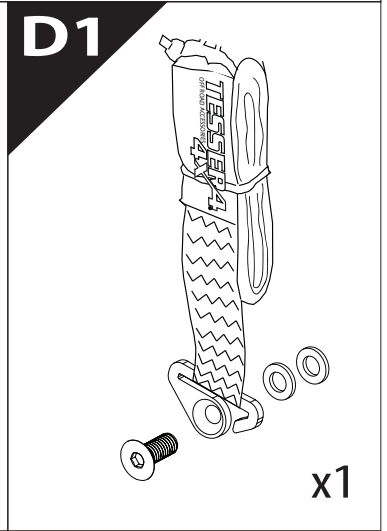
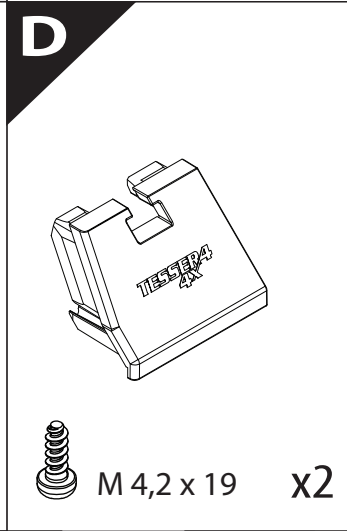
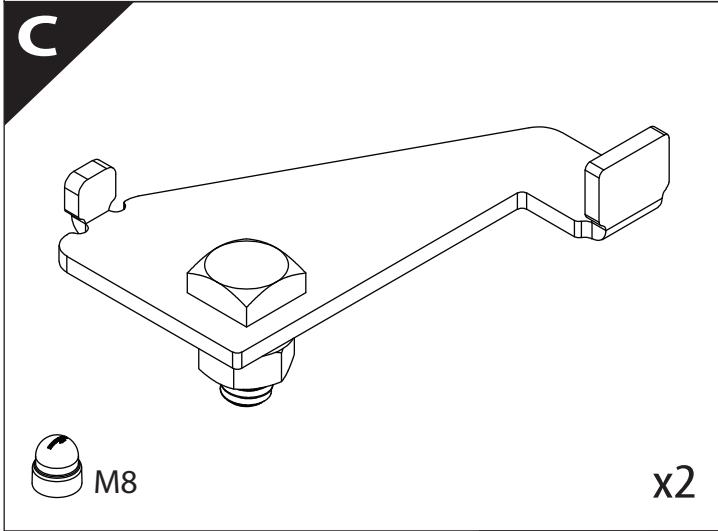
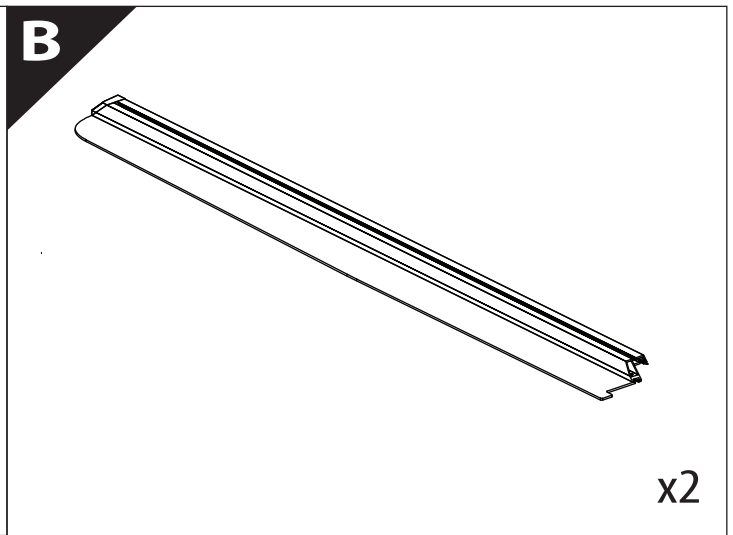
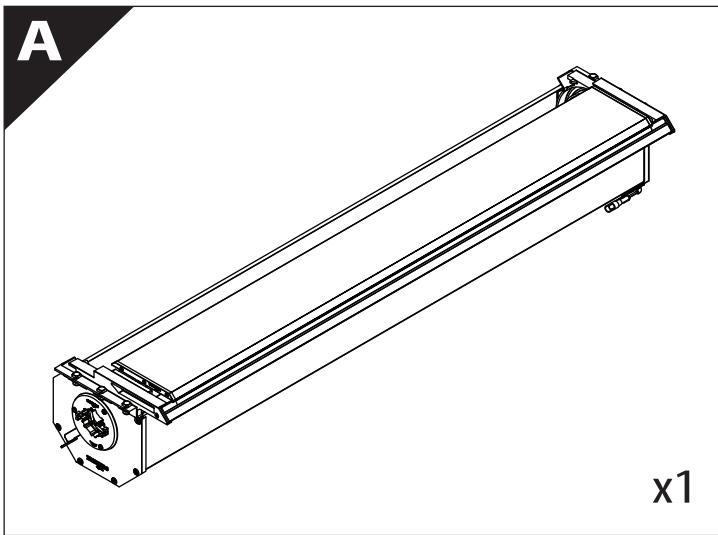
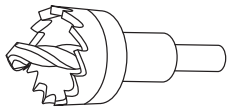

Ø 25 mm

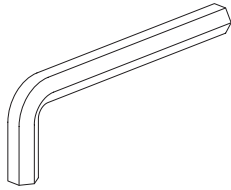
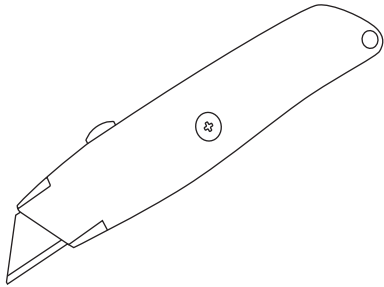
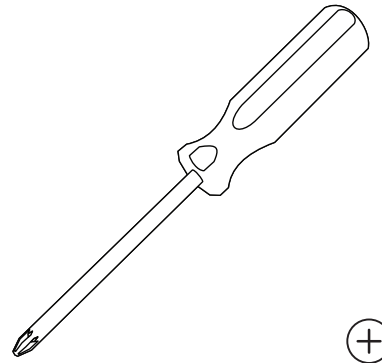
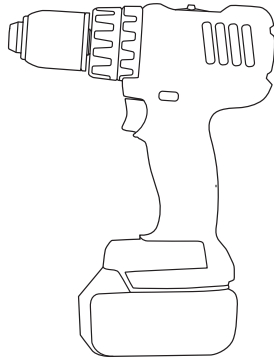

4 mm

1 - 25 Nm

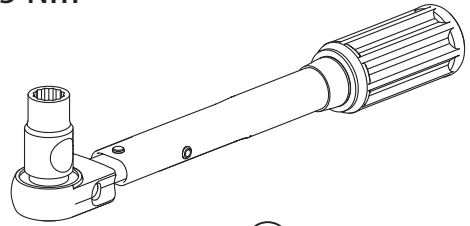

13, 17 mm



ACETONE

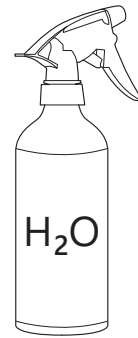
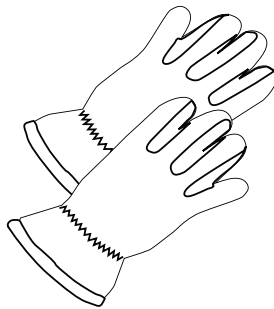
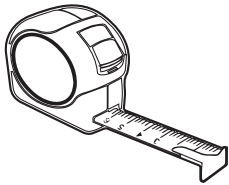

H<sub>2</sub>O

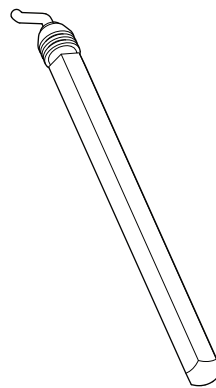
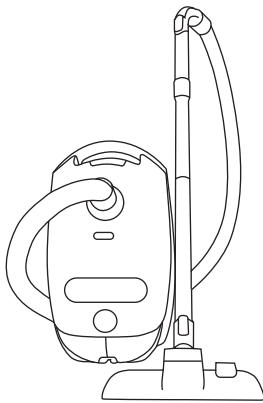
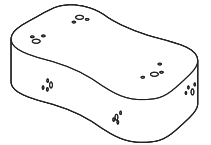

ANTI-RUST



INSTALLATION  
MANUAL

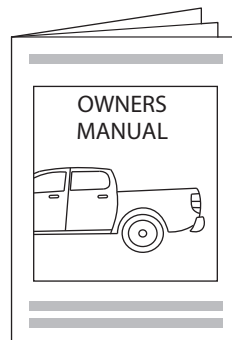

OWNERS  
MANUAL

x1

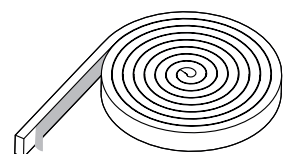
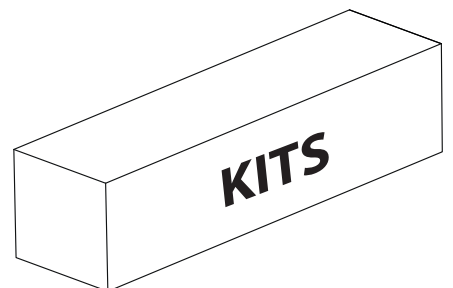
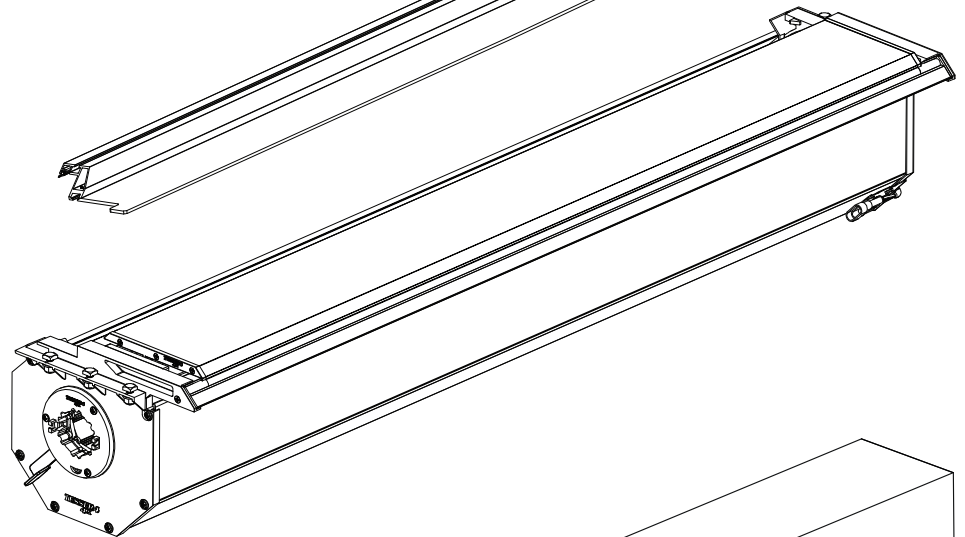
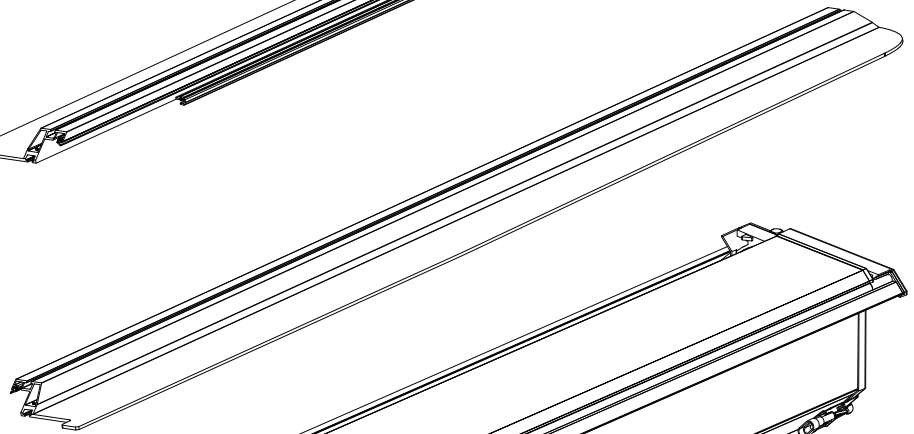
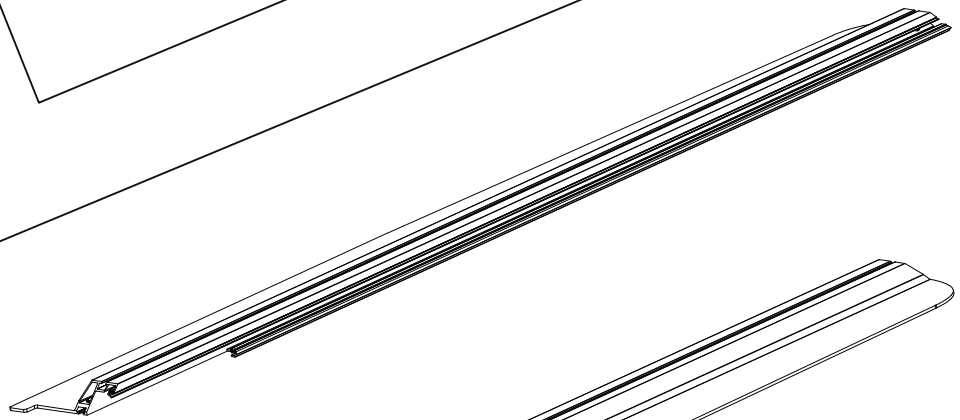
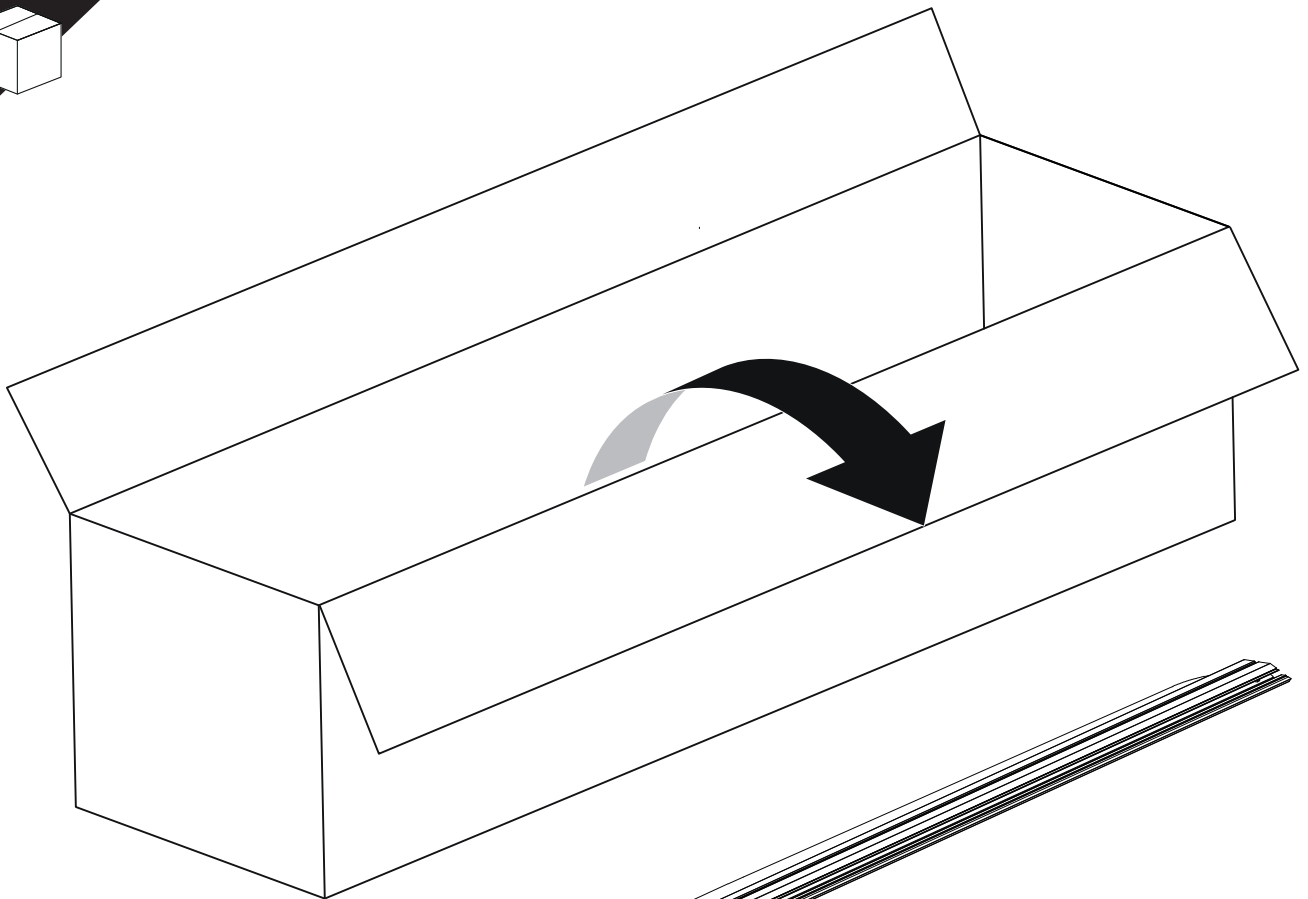

**B**

**A**

**KITS**

**G**

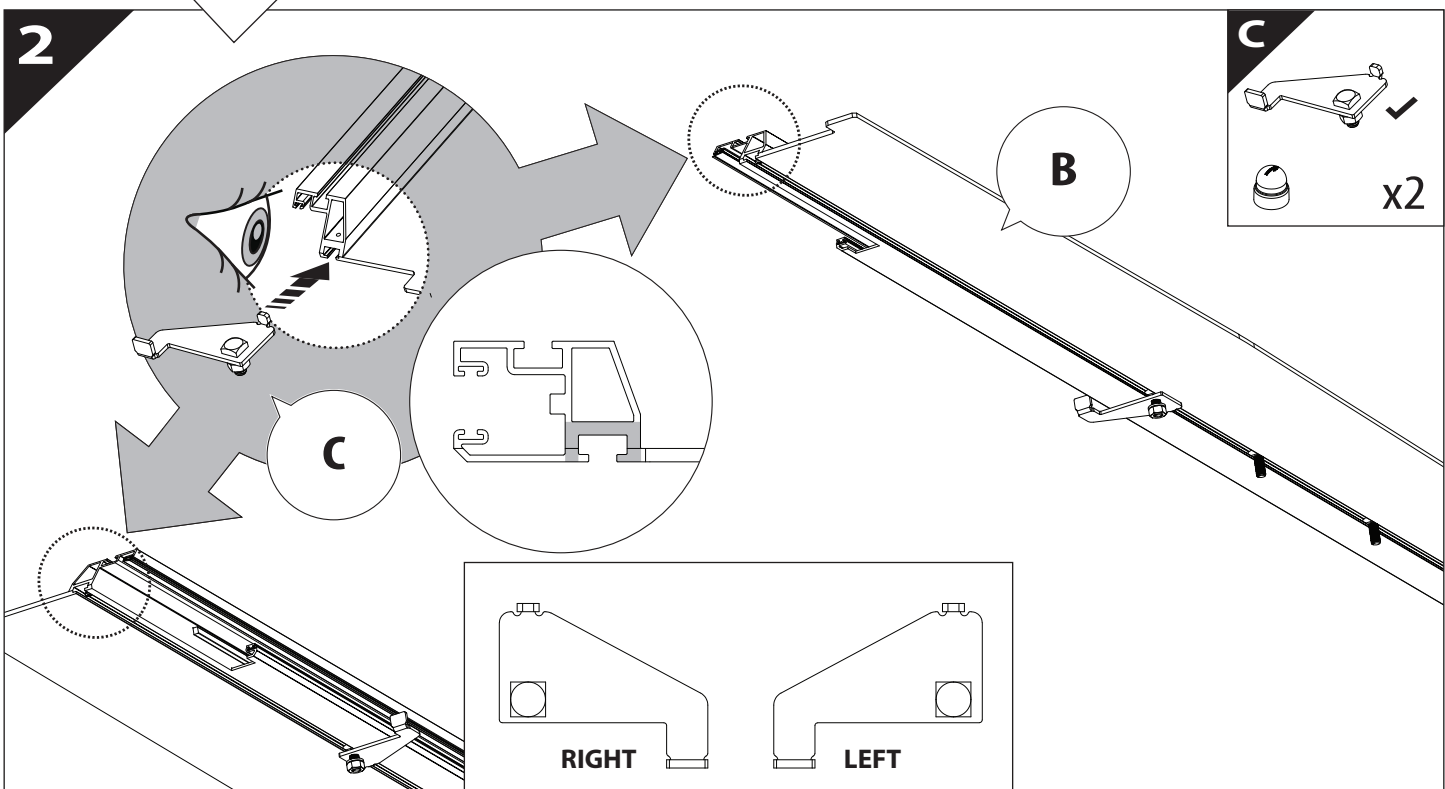
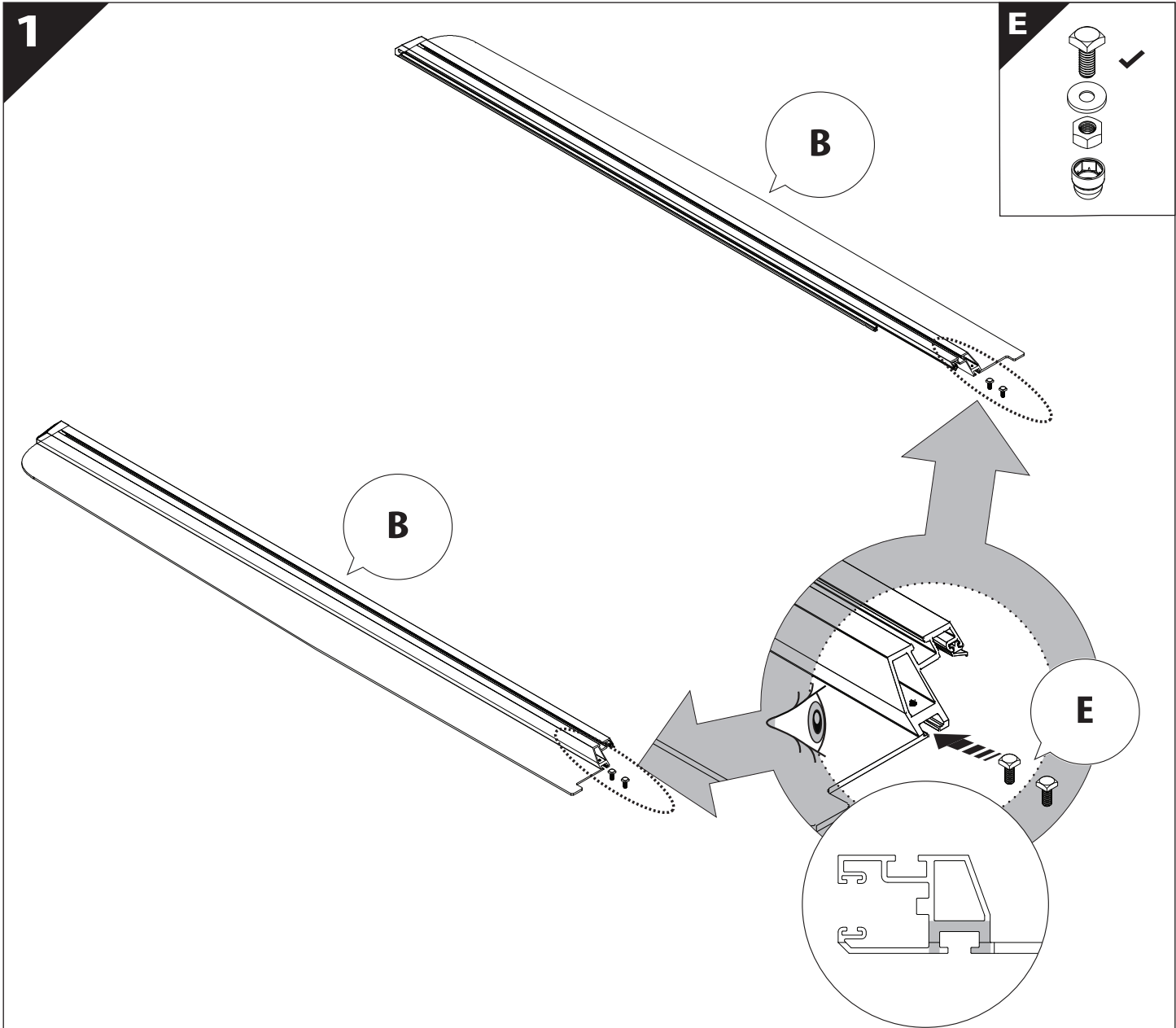

3

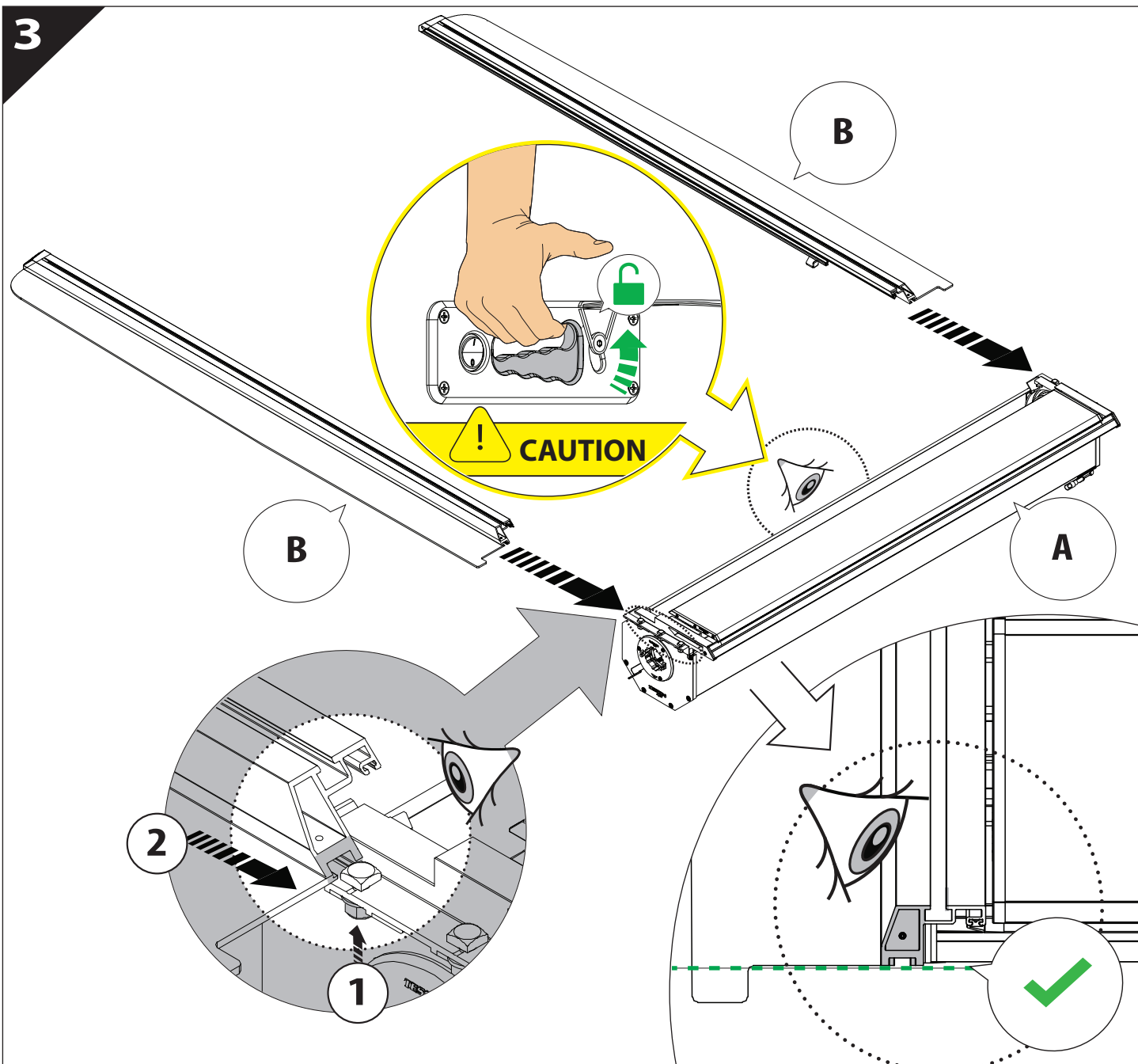

4

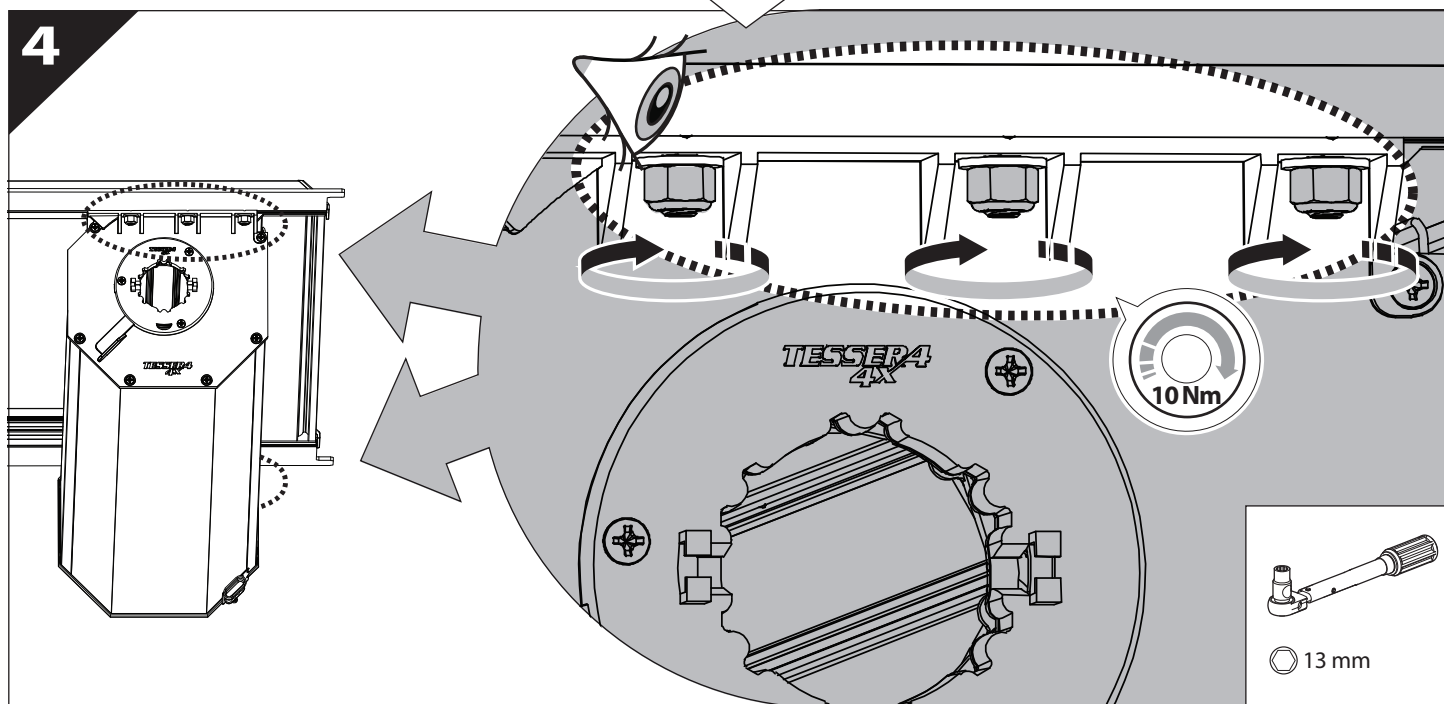



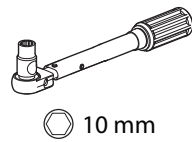
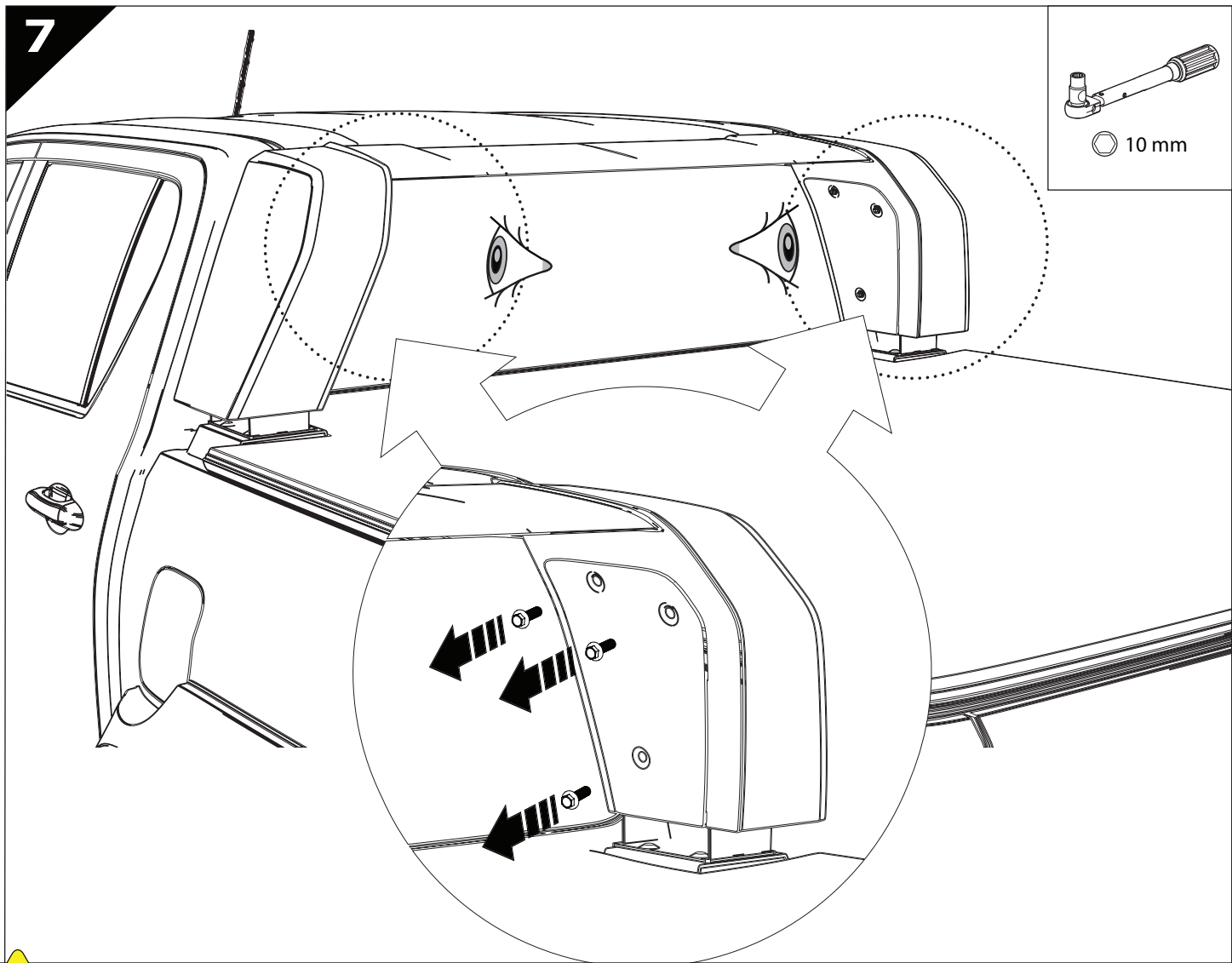

7



10 mm

 **REUSE IN STEP 31** 

8

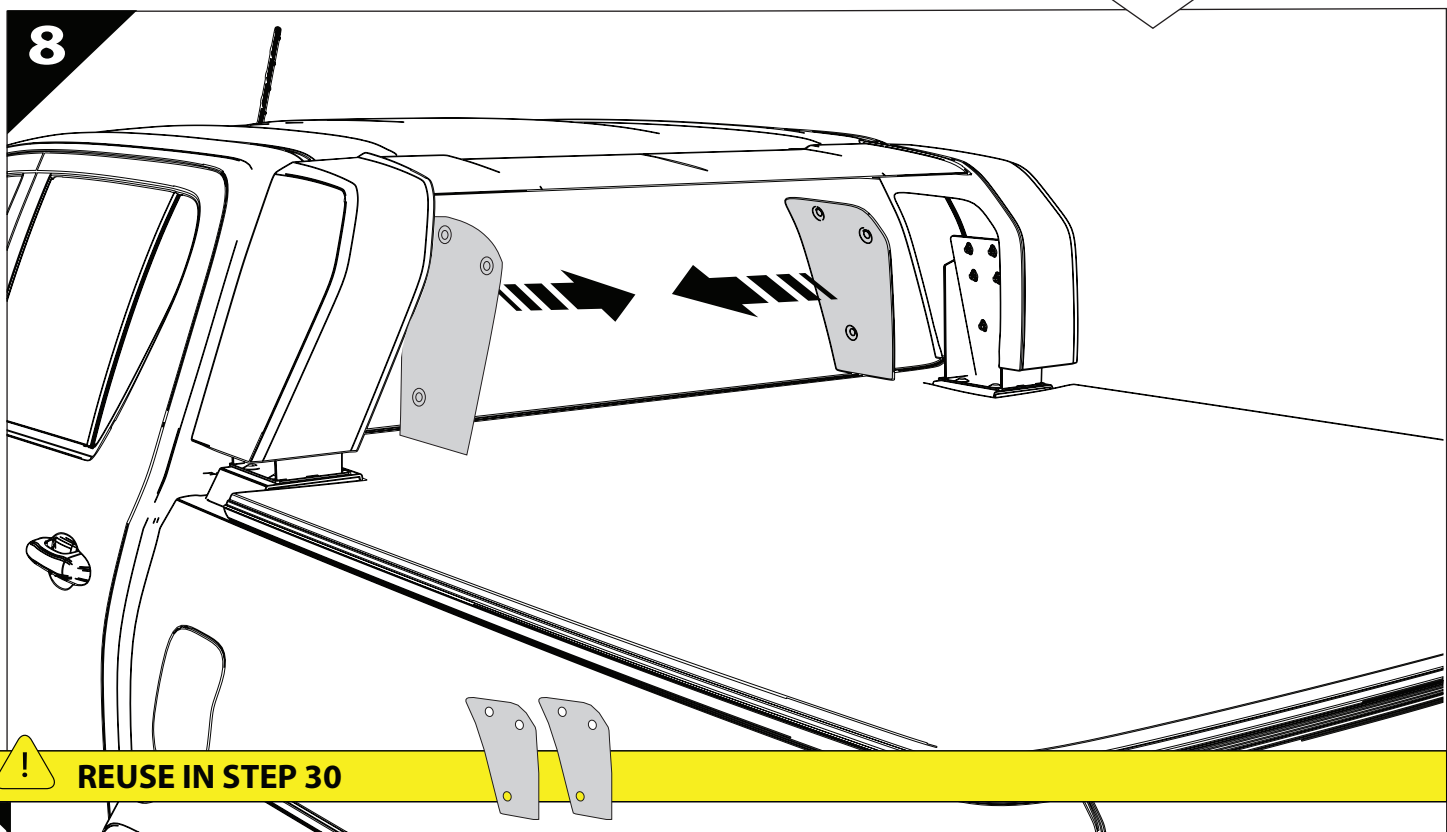

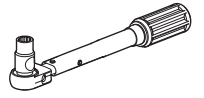

 **REUSE IN STEP 30** 

9

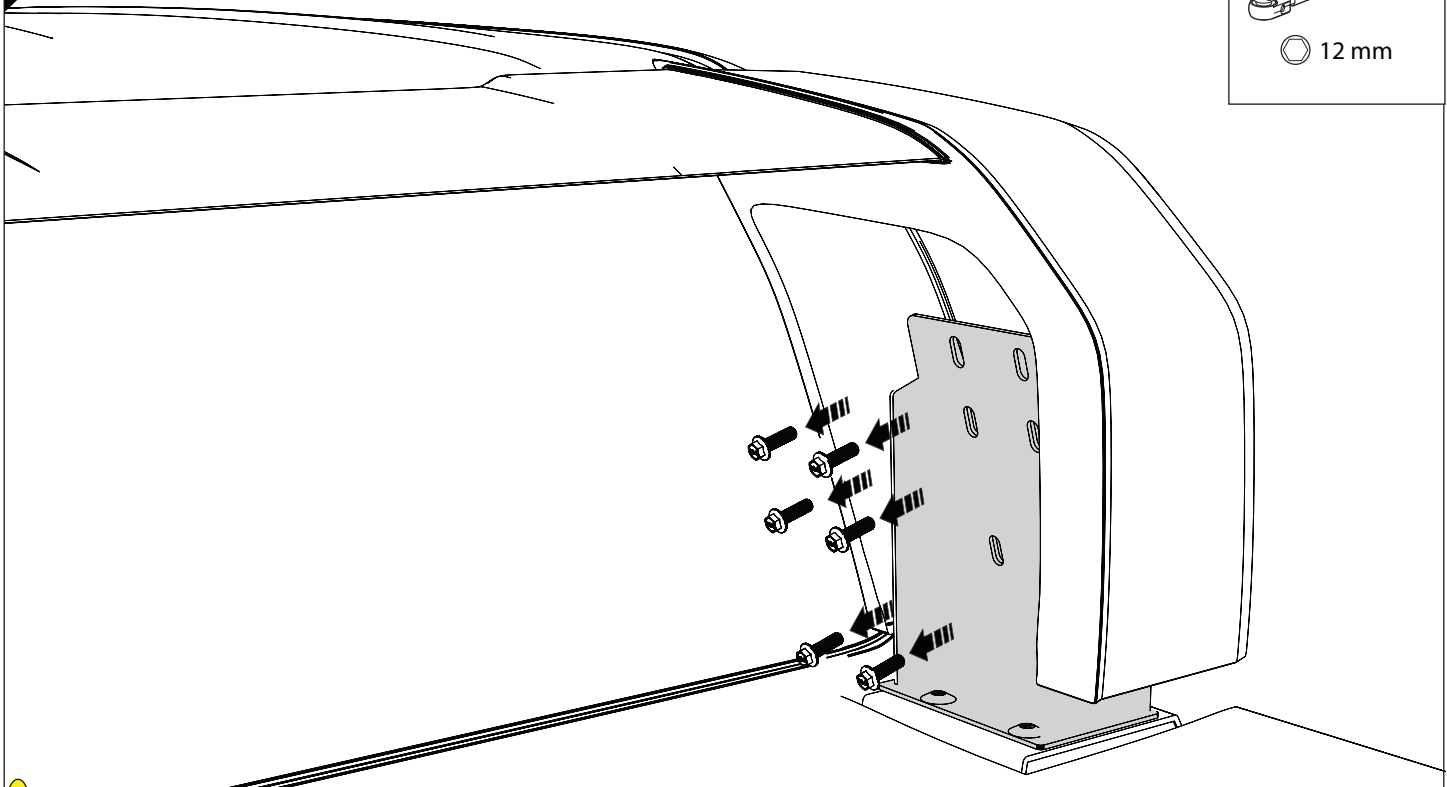

12 mm

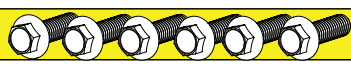
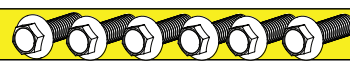

 **REUSE IN STEP 29**  

10

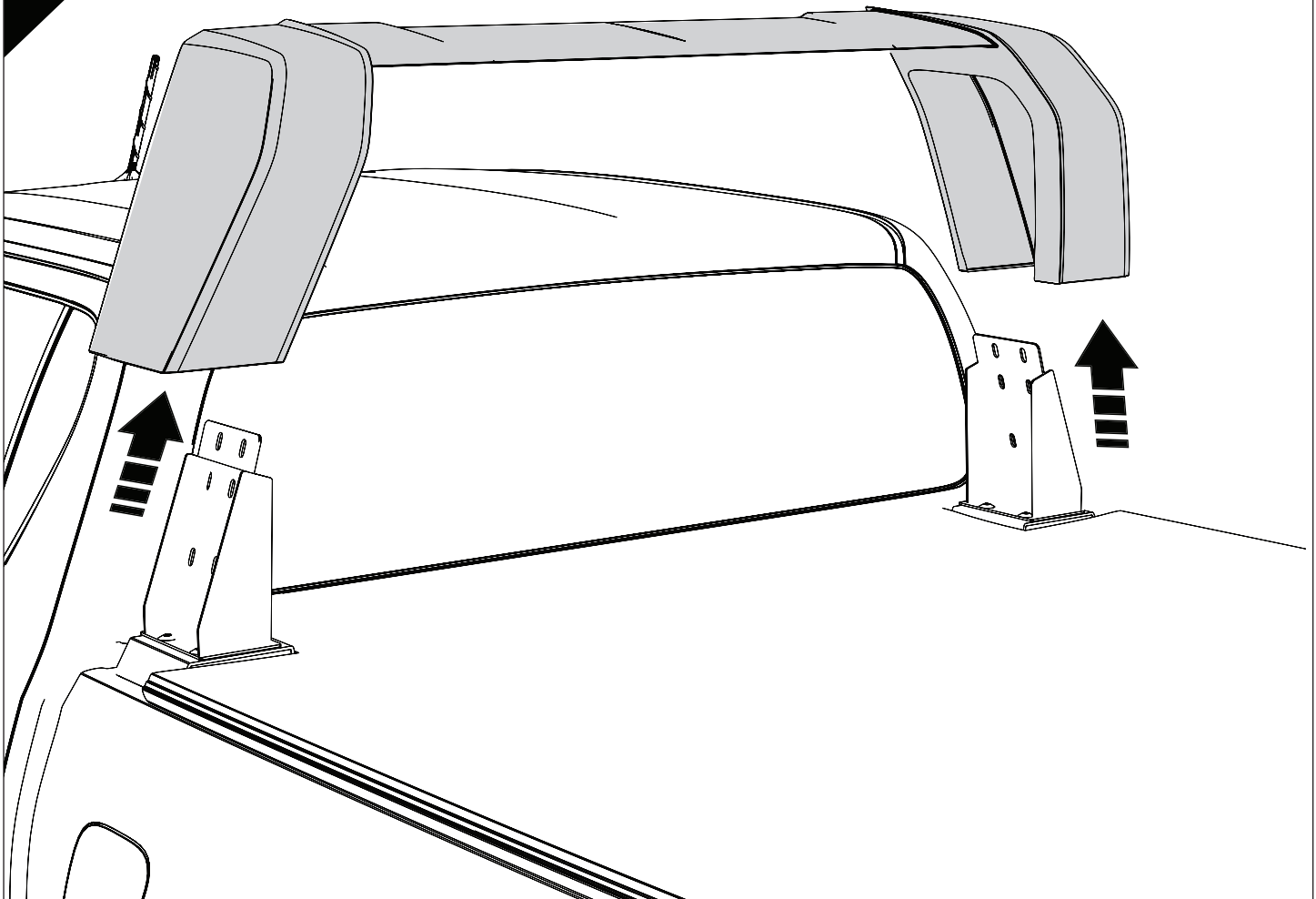

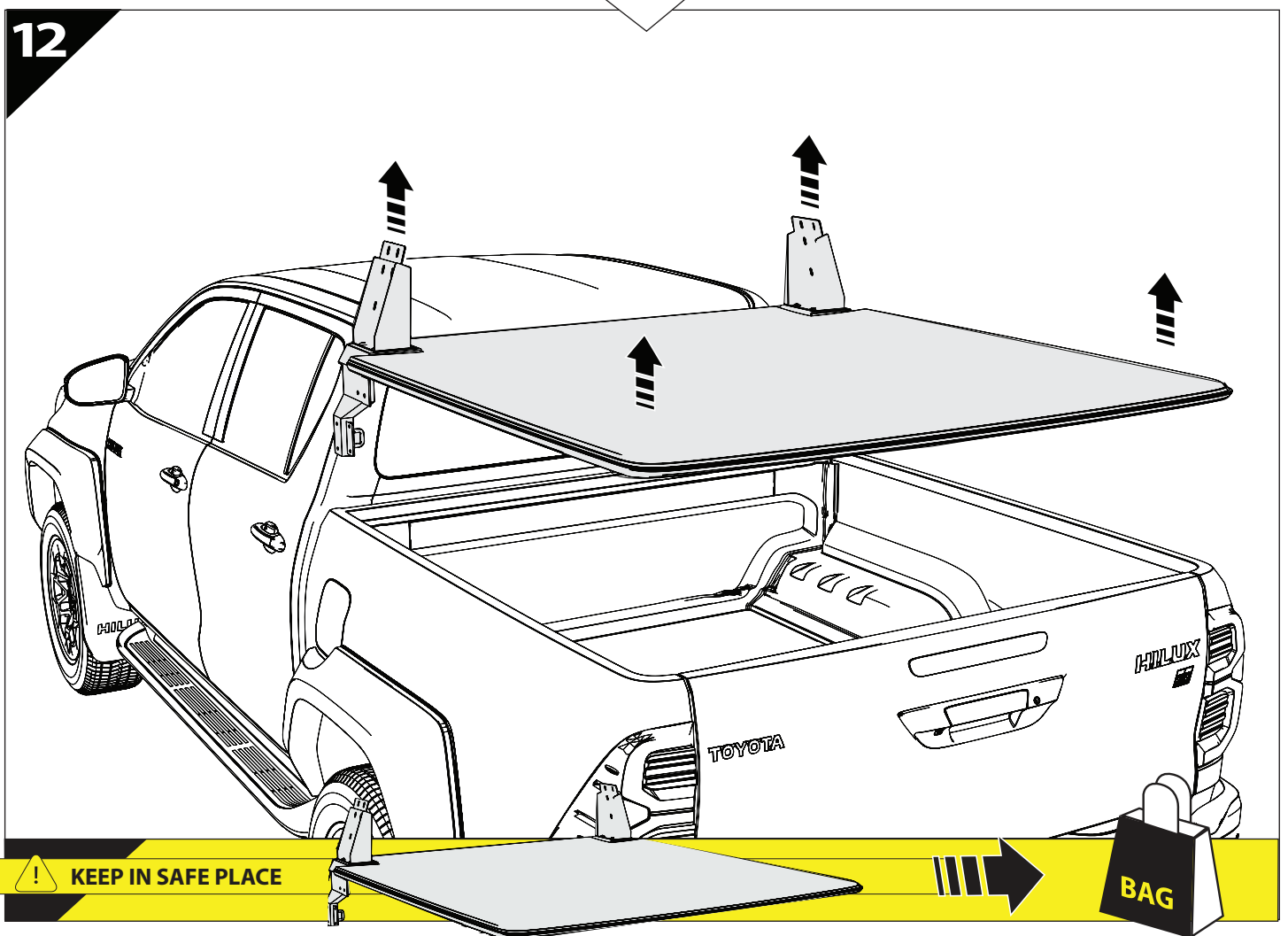
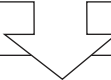
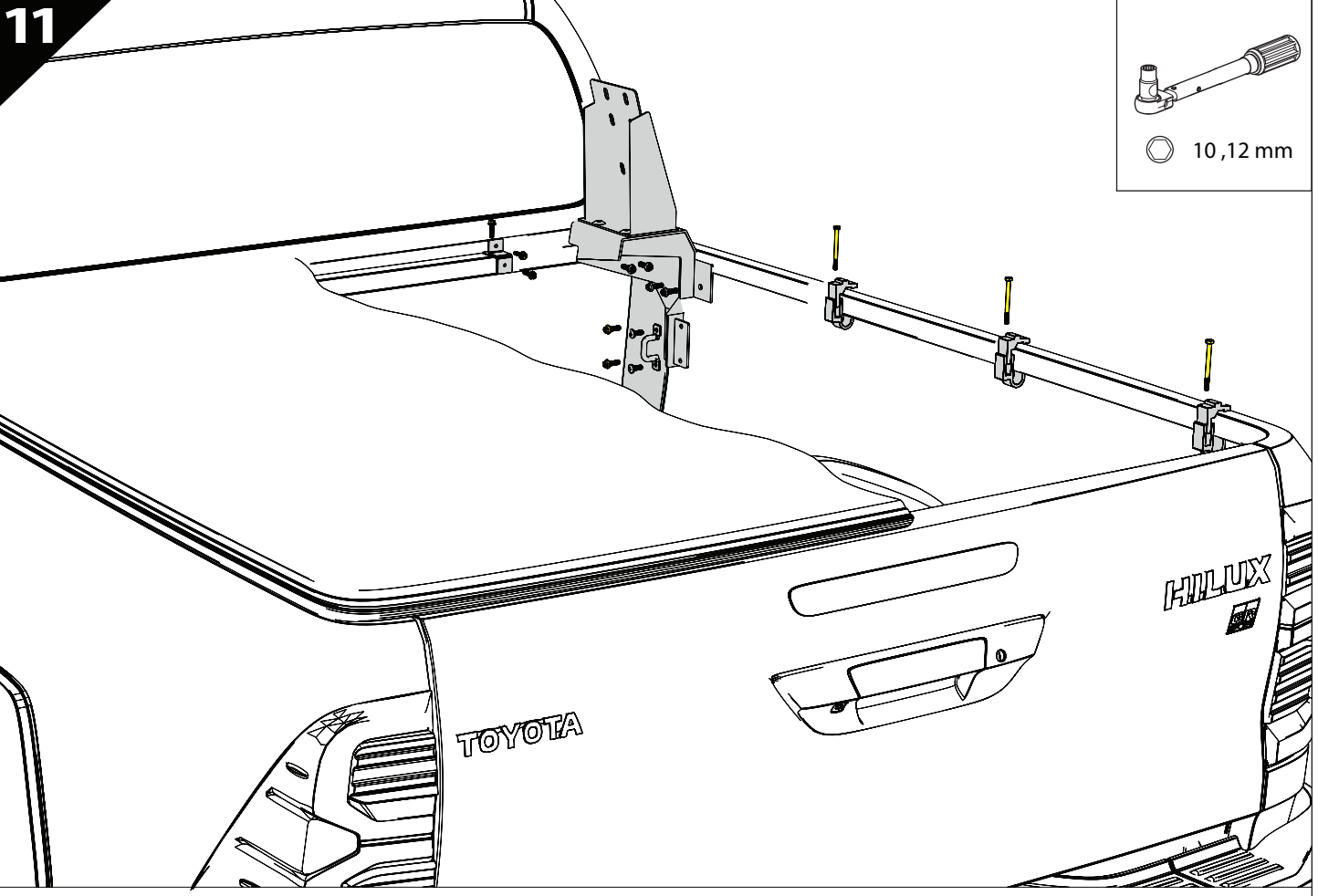

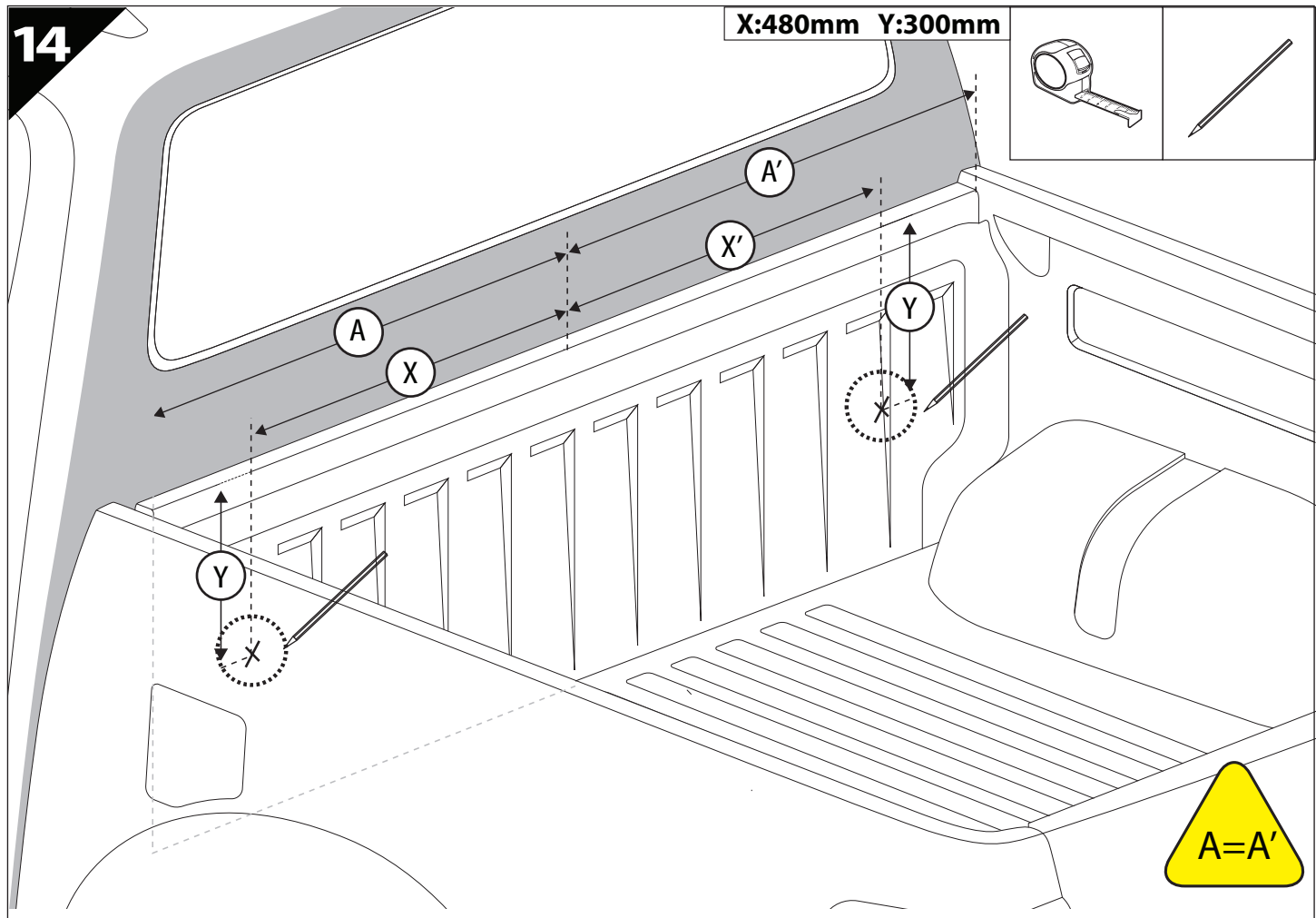
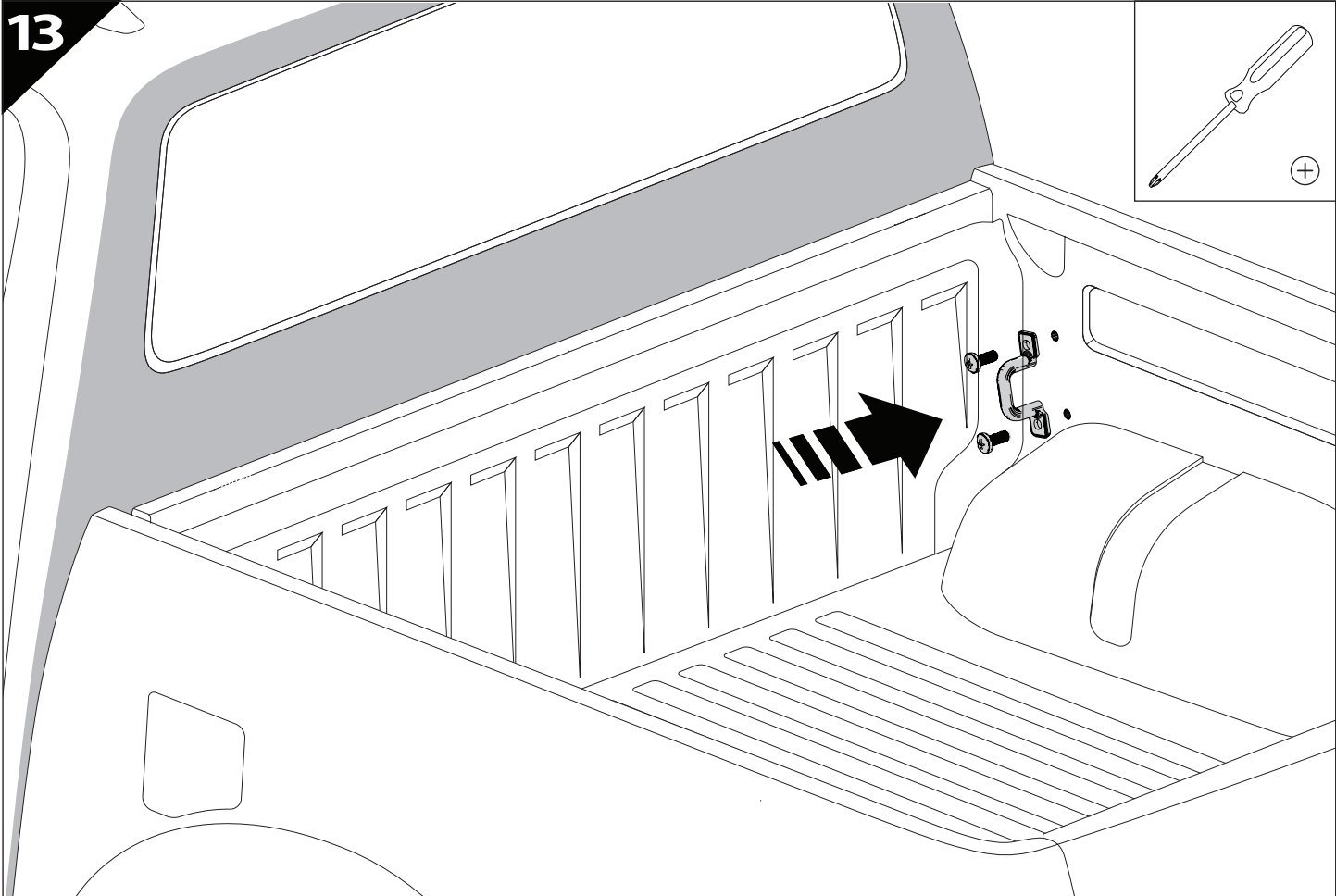

15

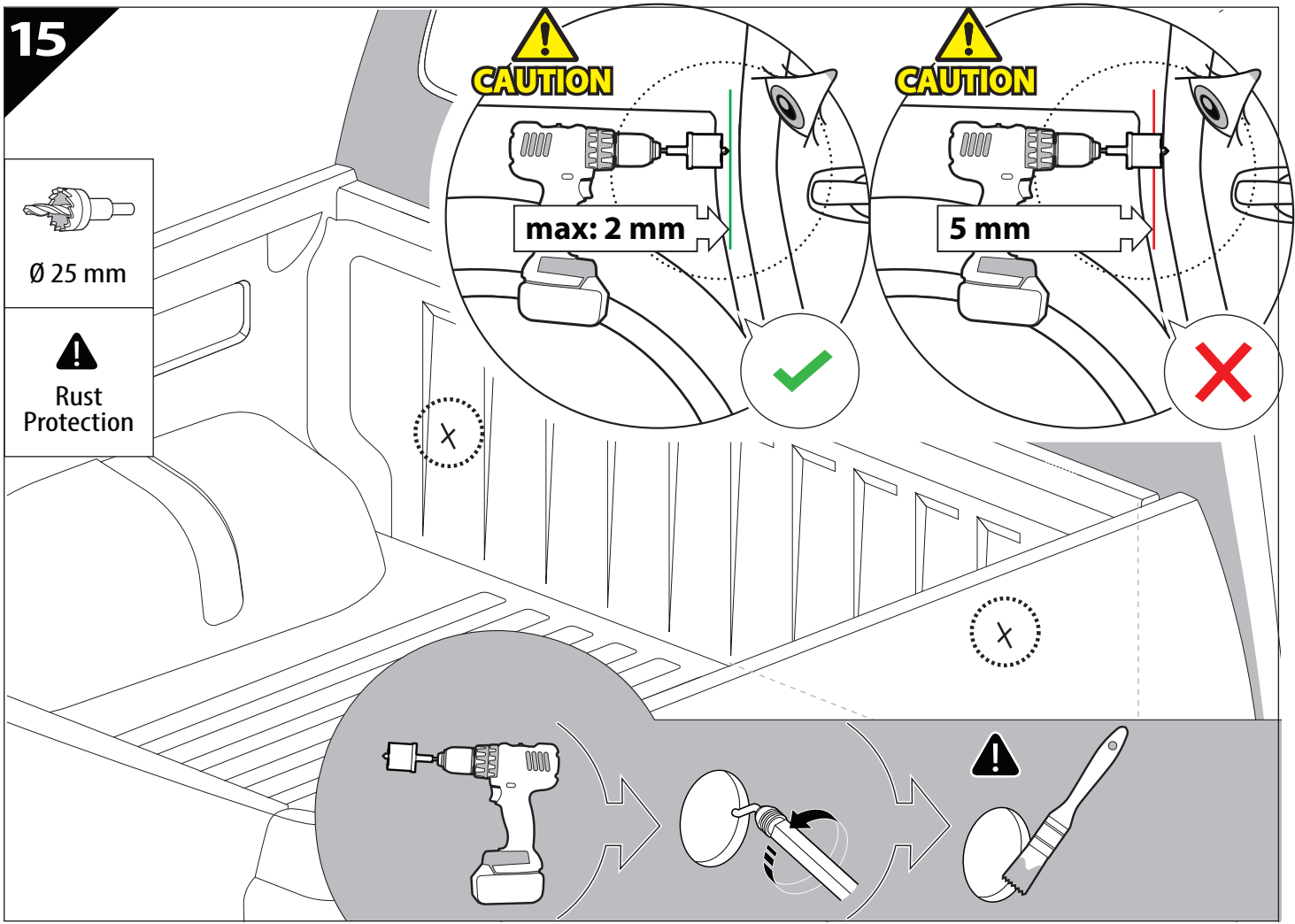

16

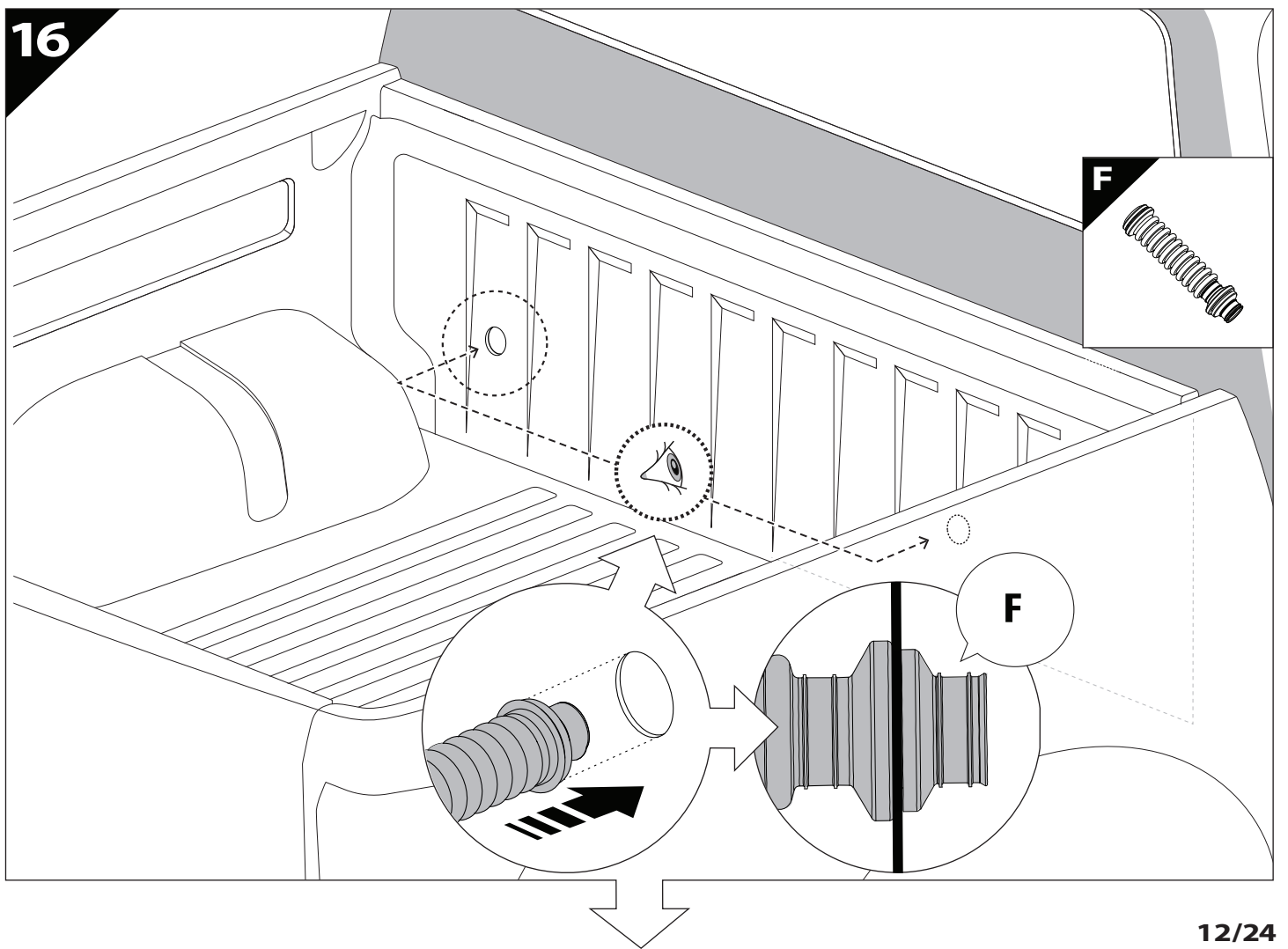

17

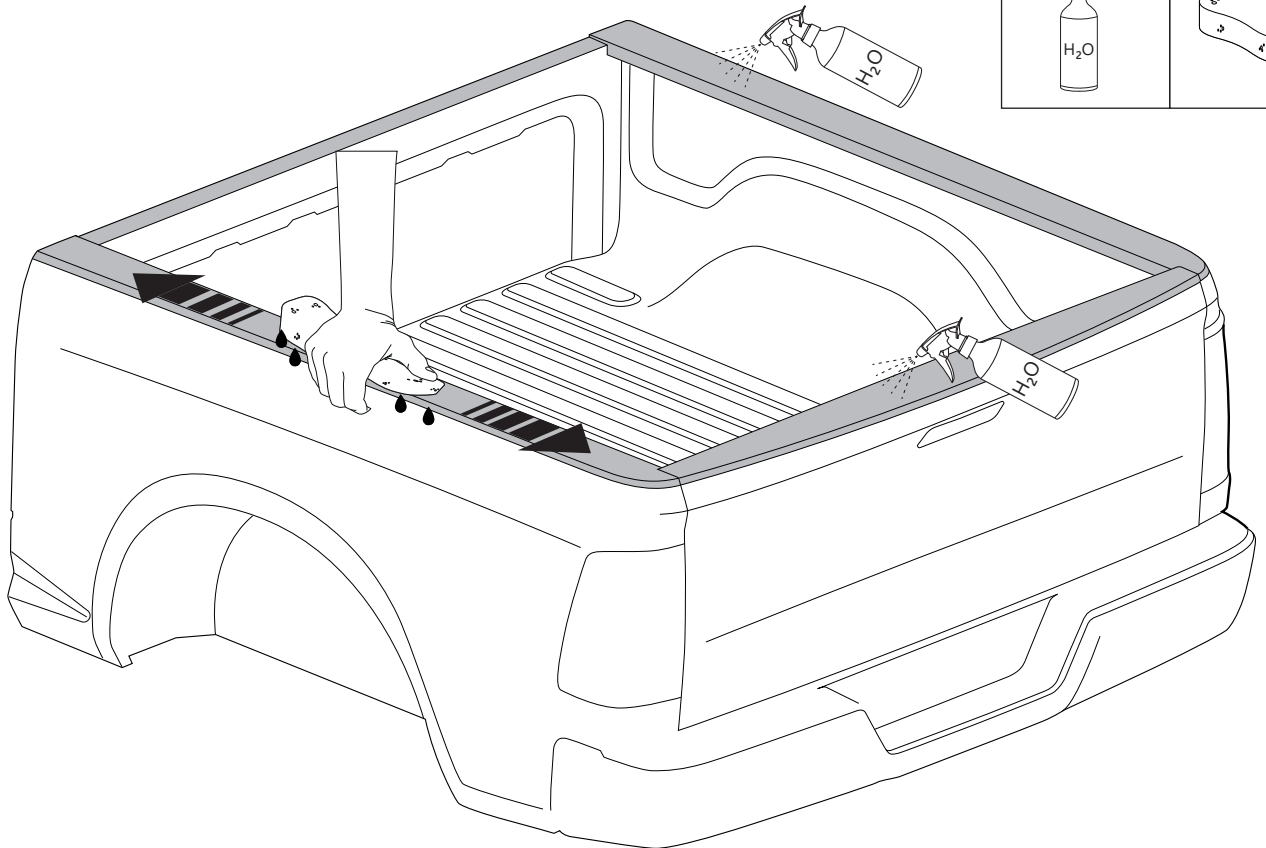

18

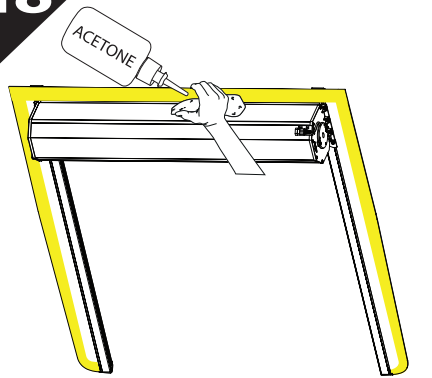

G1

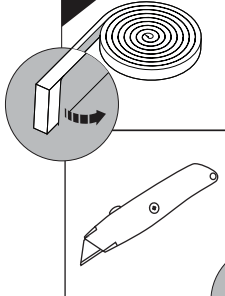

19

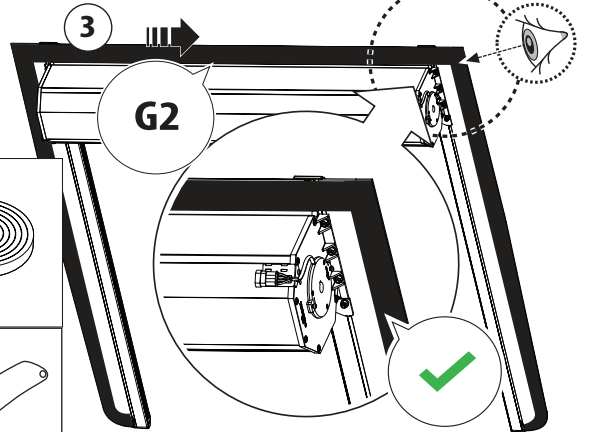

G2

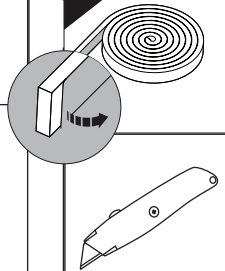

1

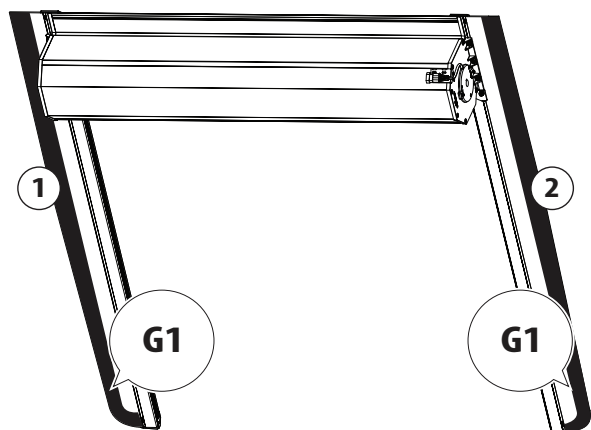

2

G1

G1

3

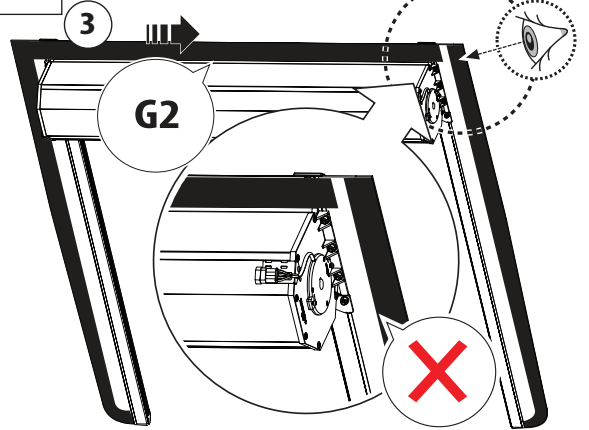

G2

20

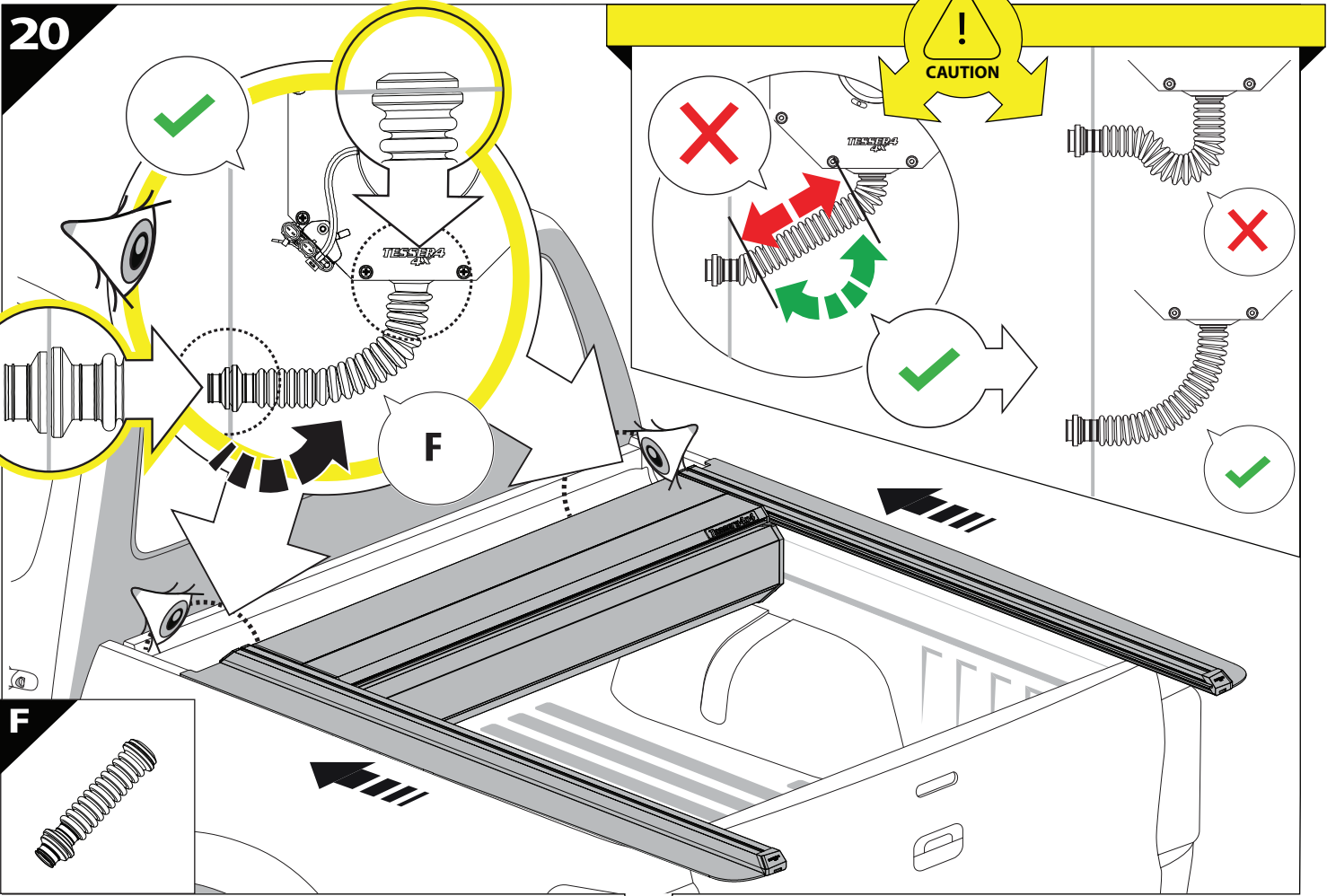

21

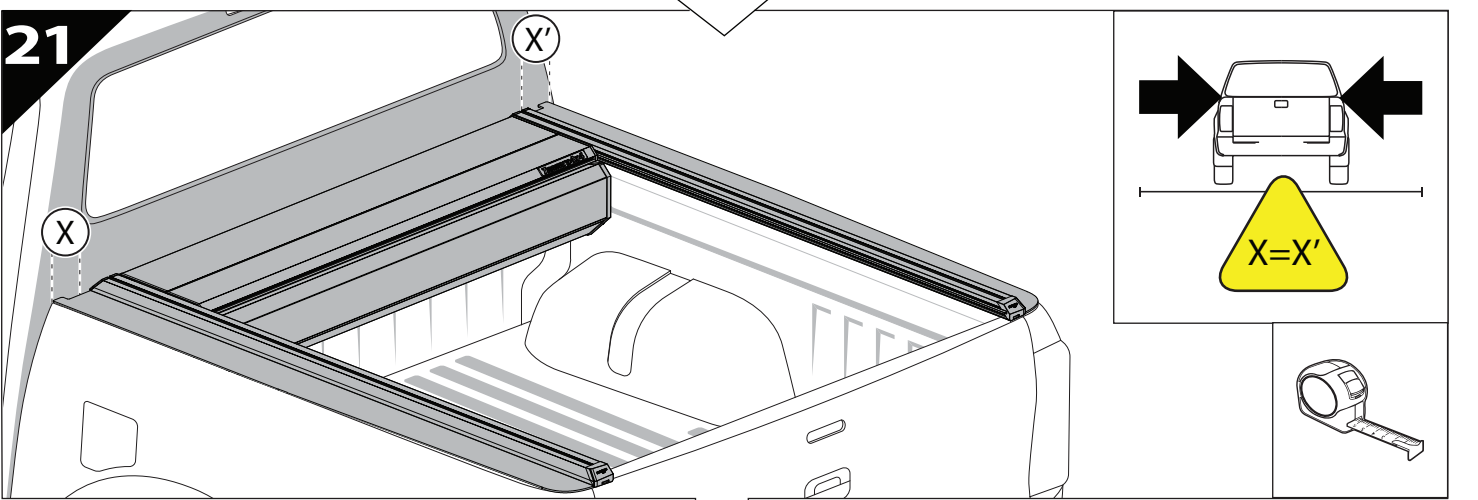

22

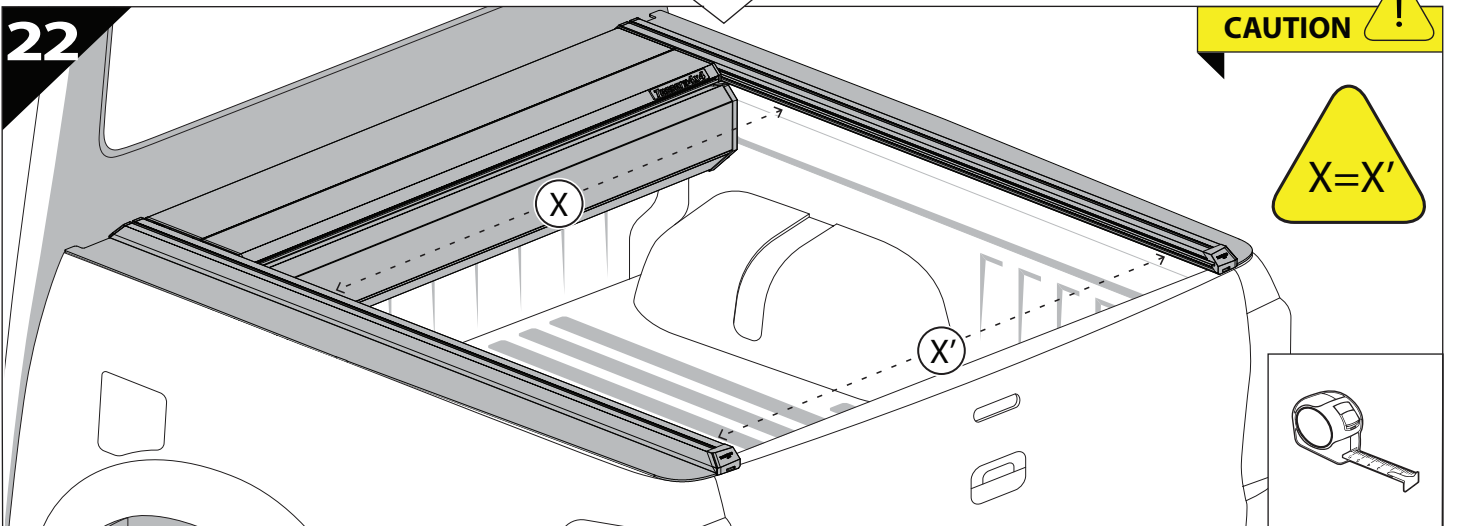

23

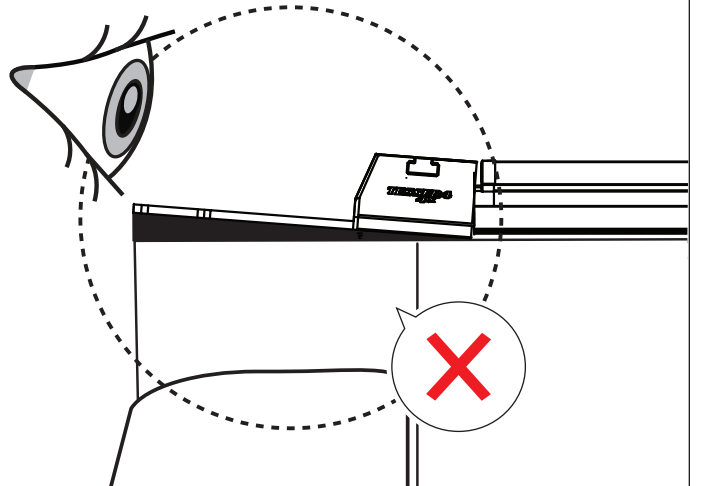
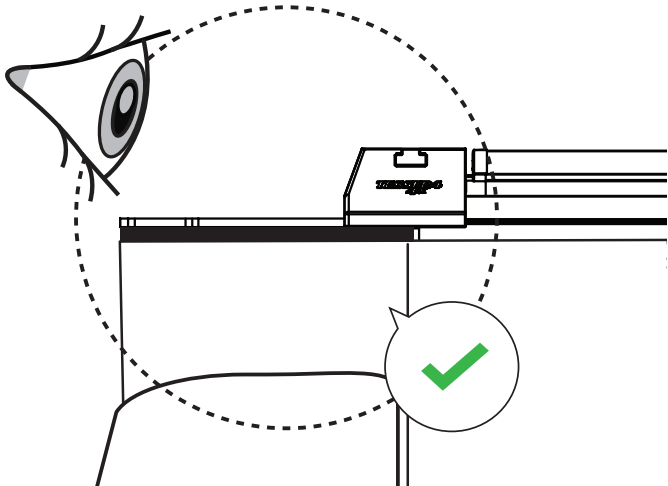
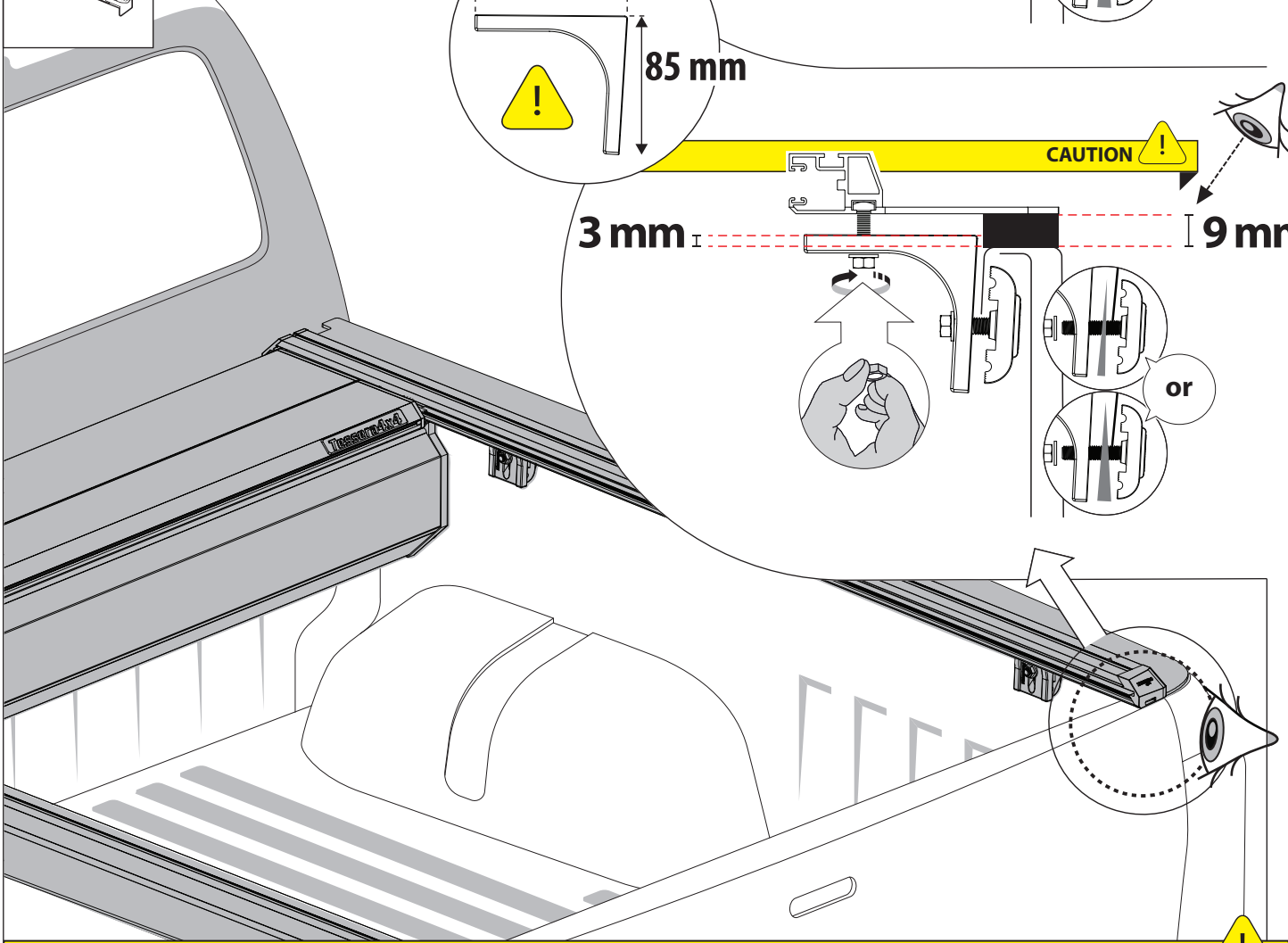
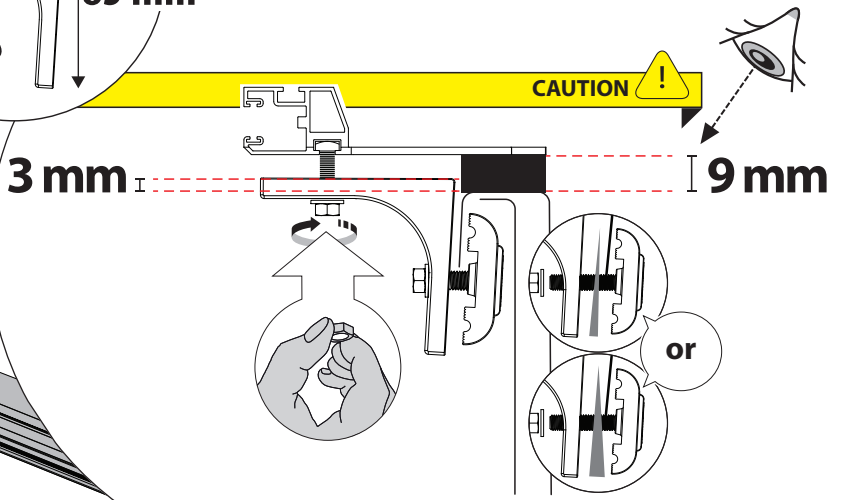
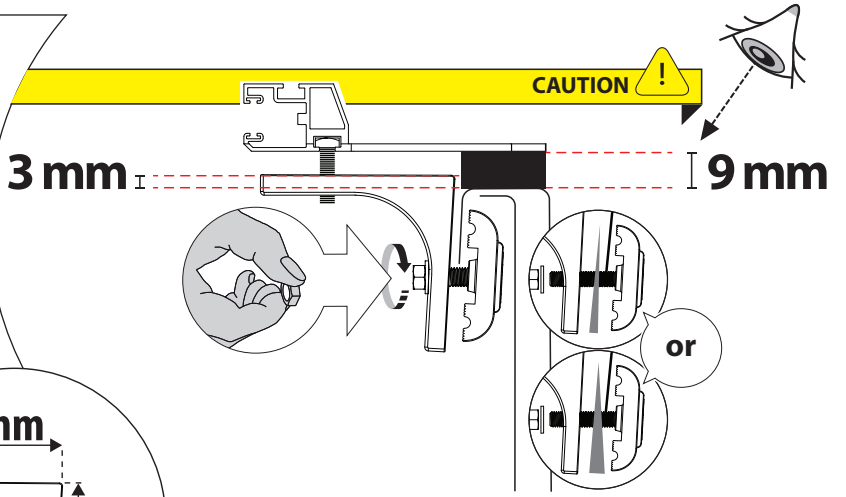
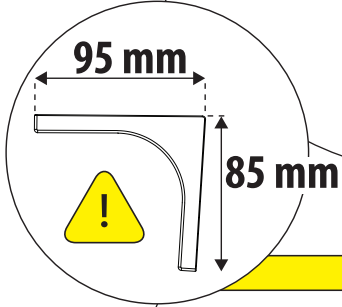
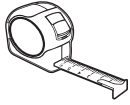
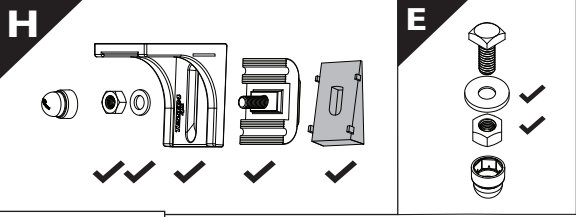

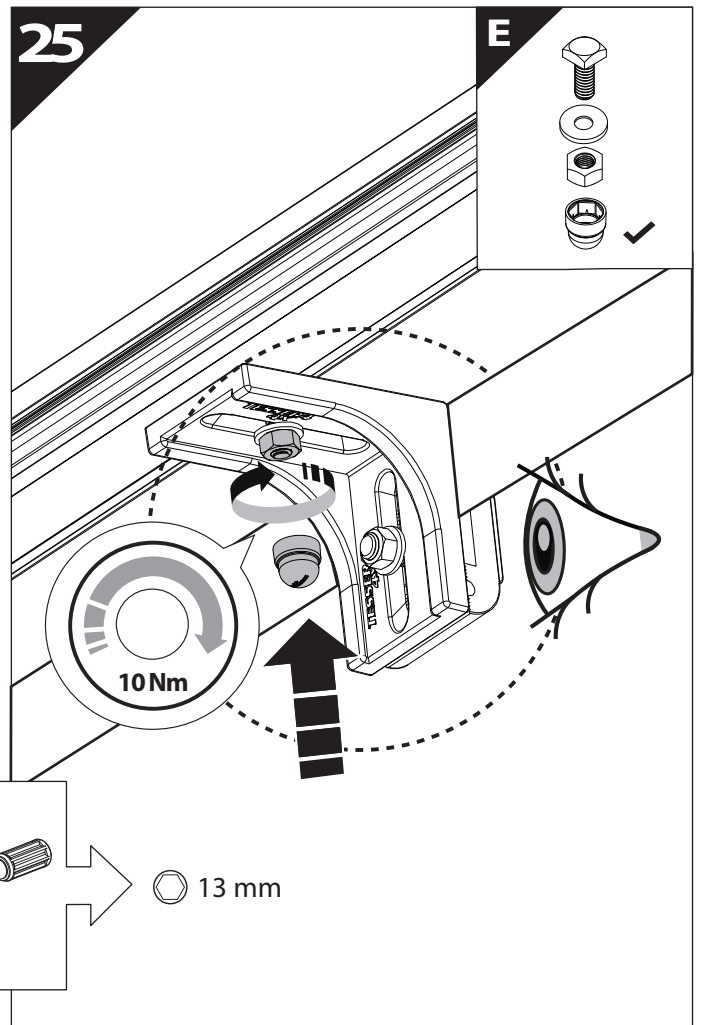
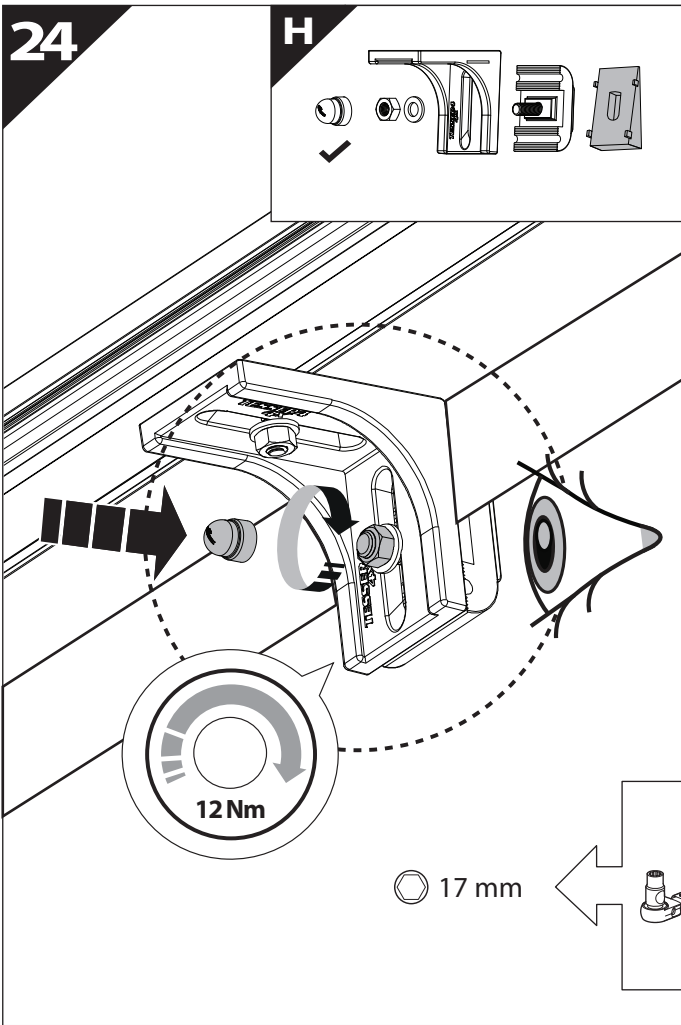

**CAUTION** !

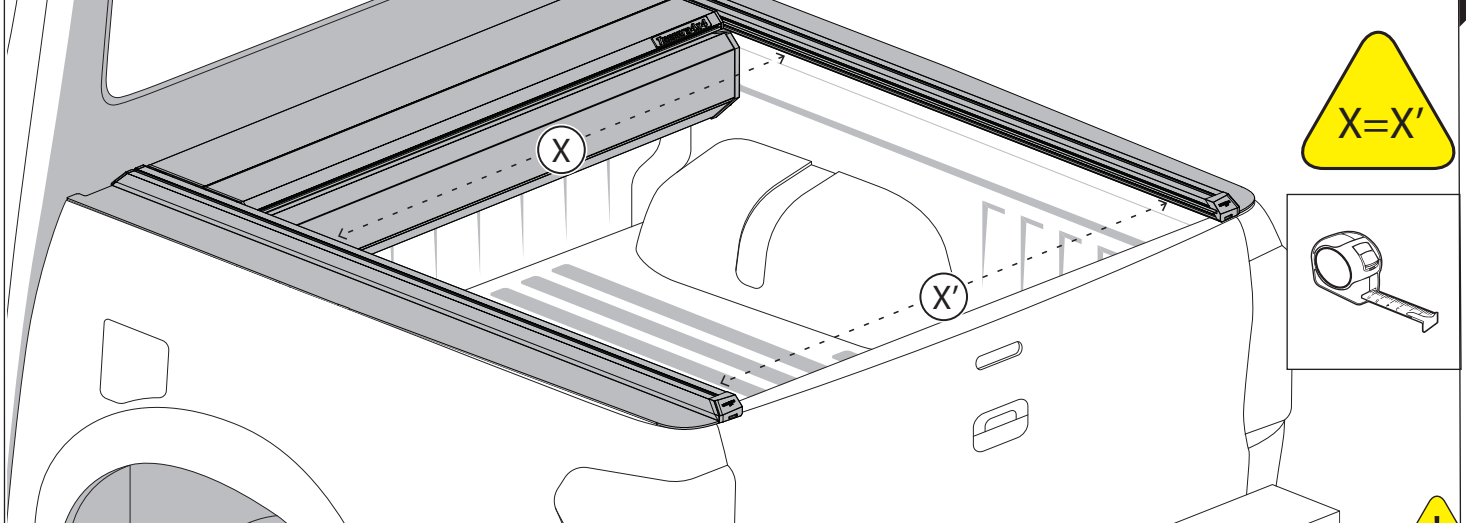

**CAUTION** !

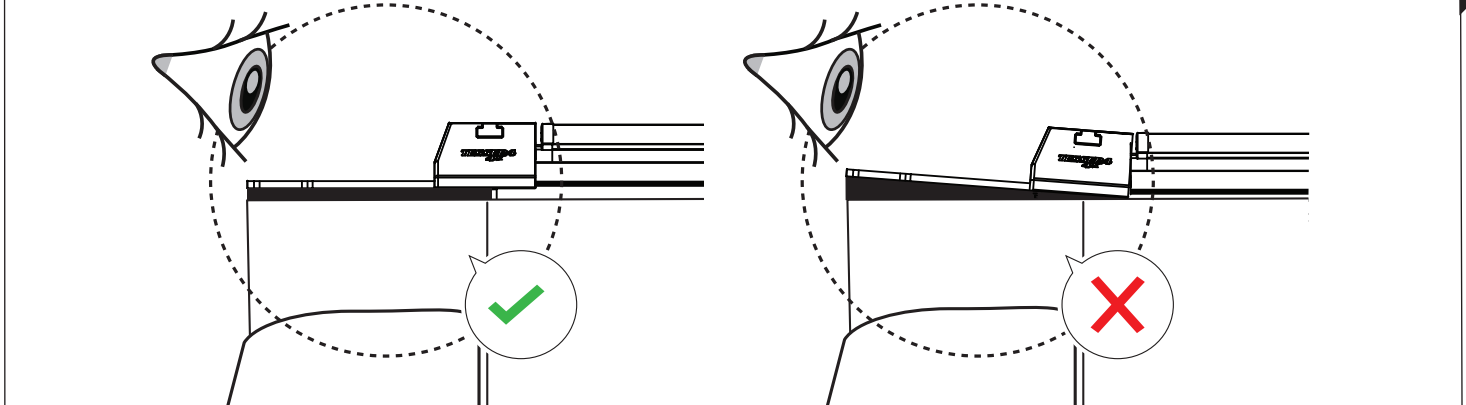

26

E1

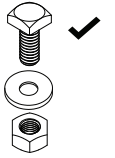

x4

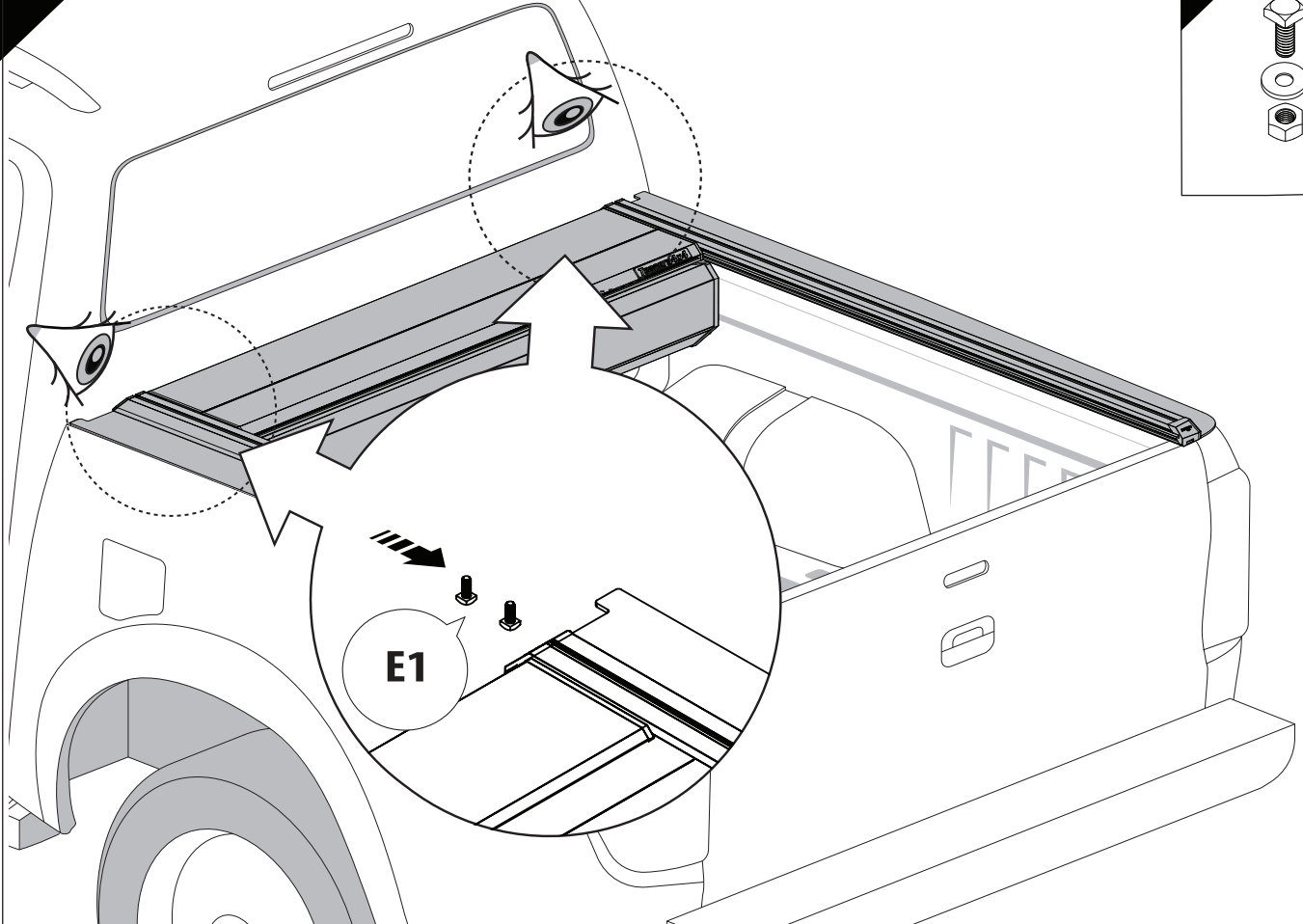

27

H1

E1

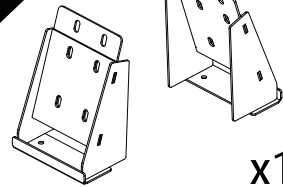

x1

x4

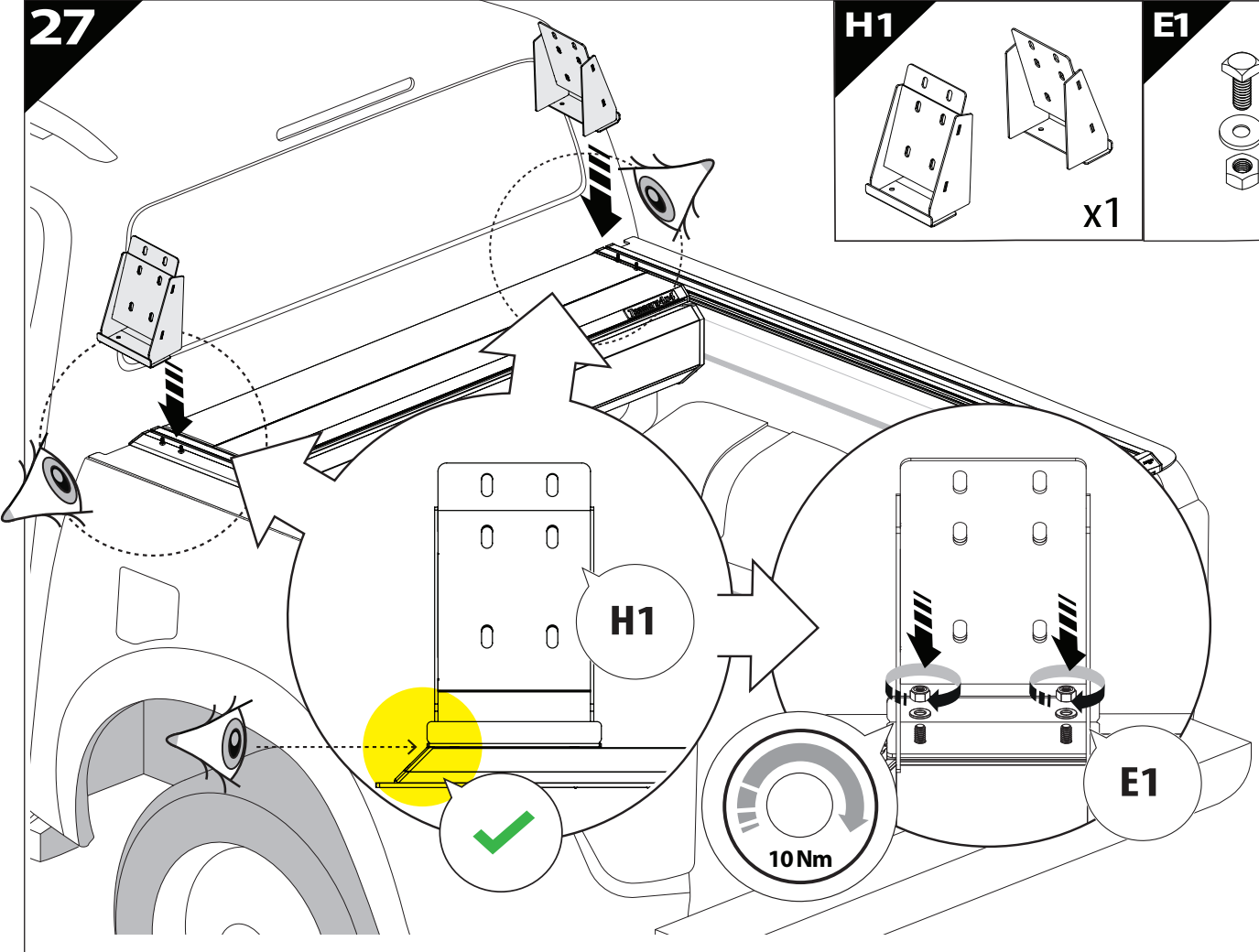

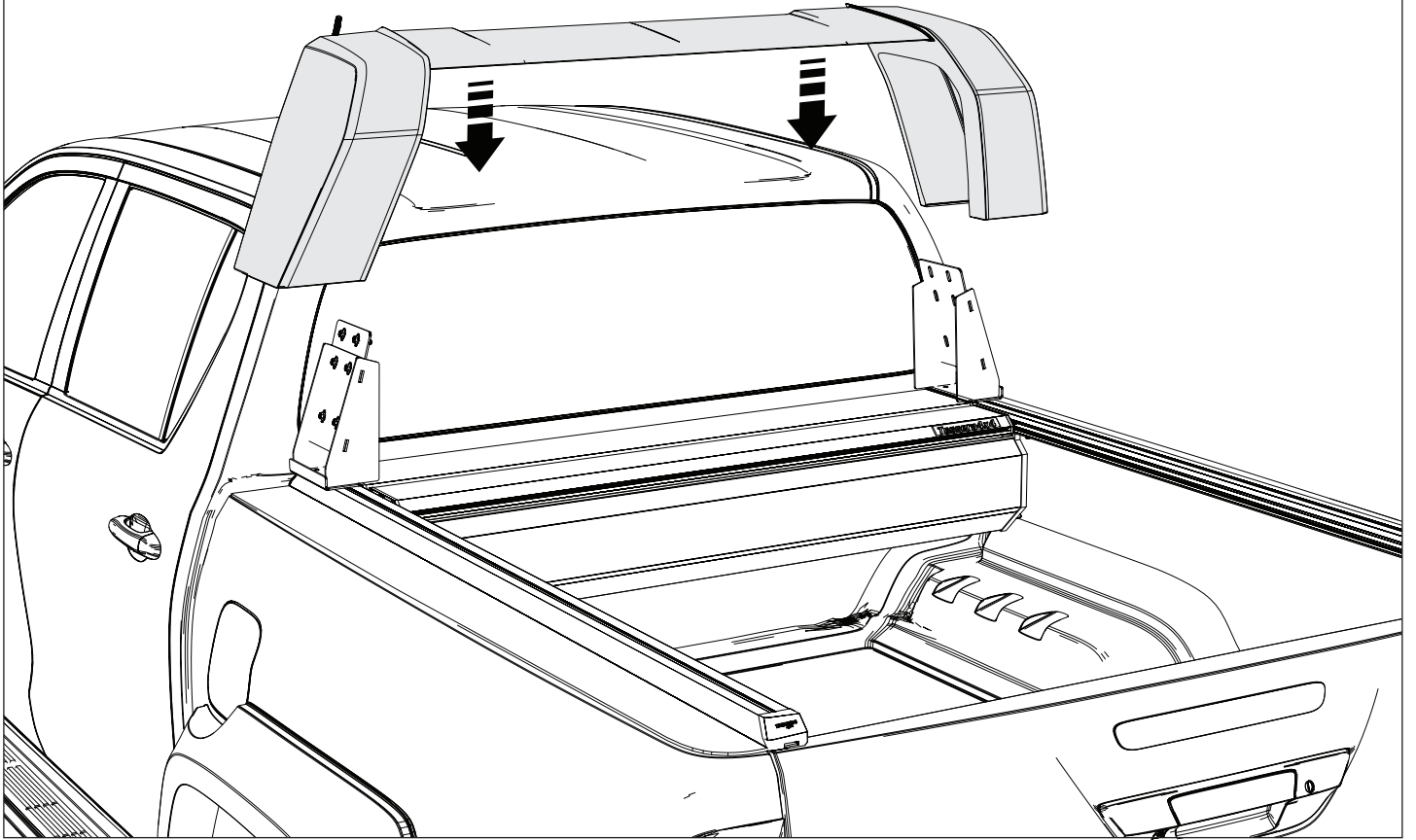

29

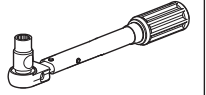

12 mm

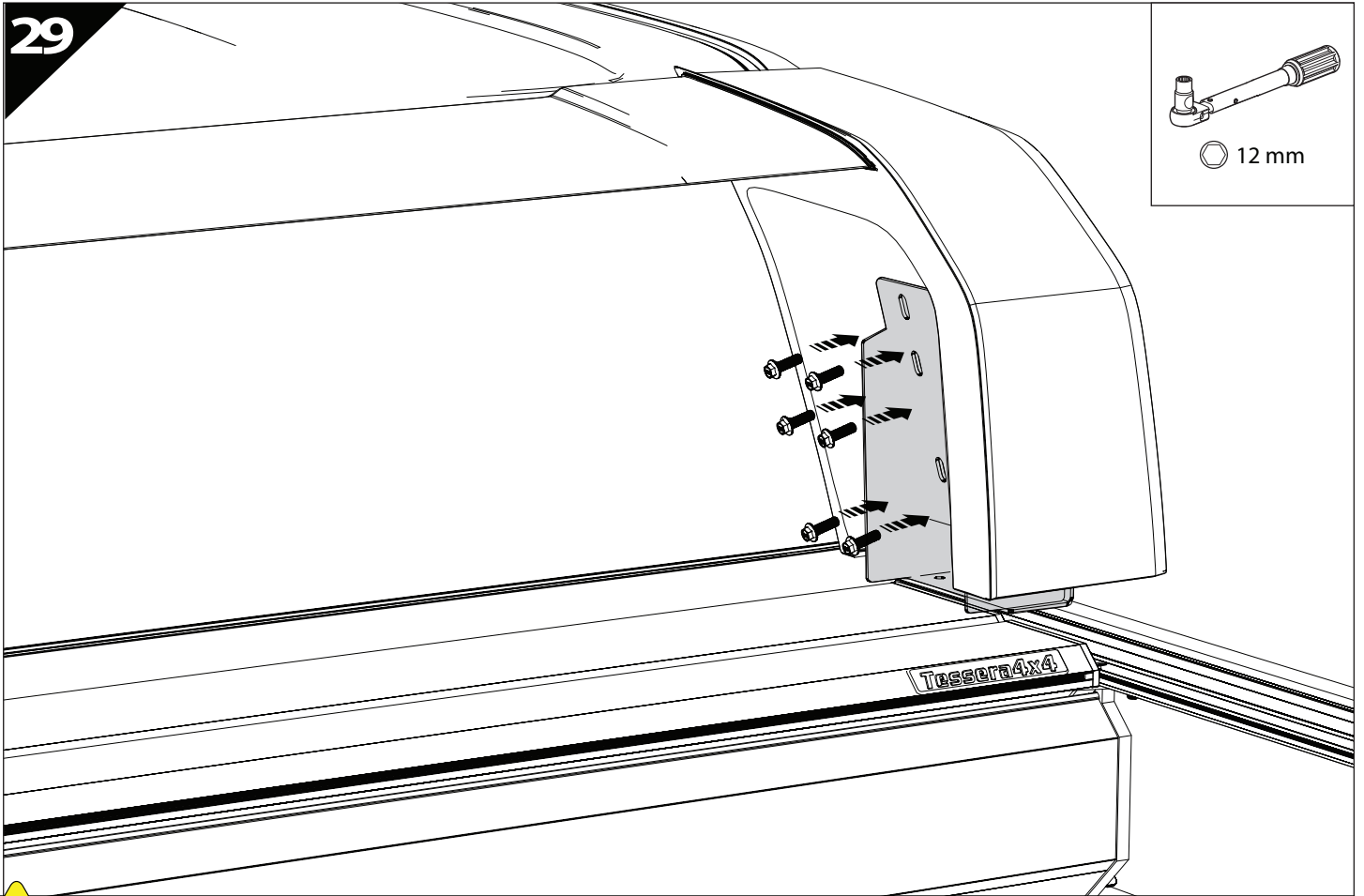

USE FROM STEP 9



30

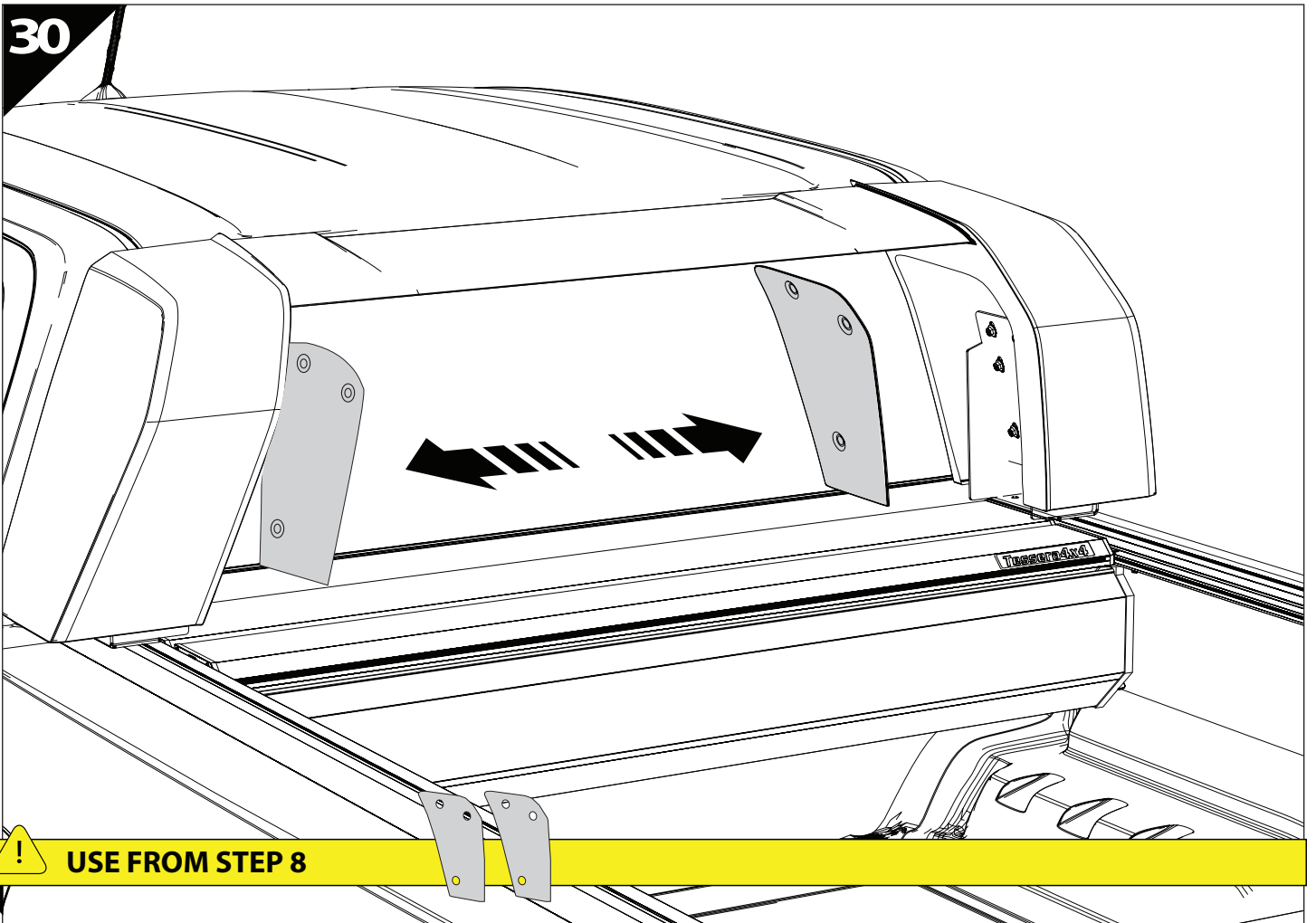

USE FROM STEP 8

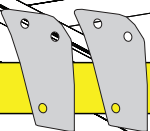

31

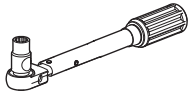

10 mm

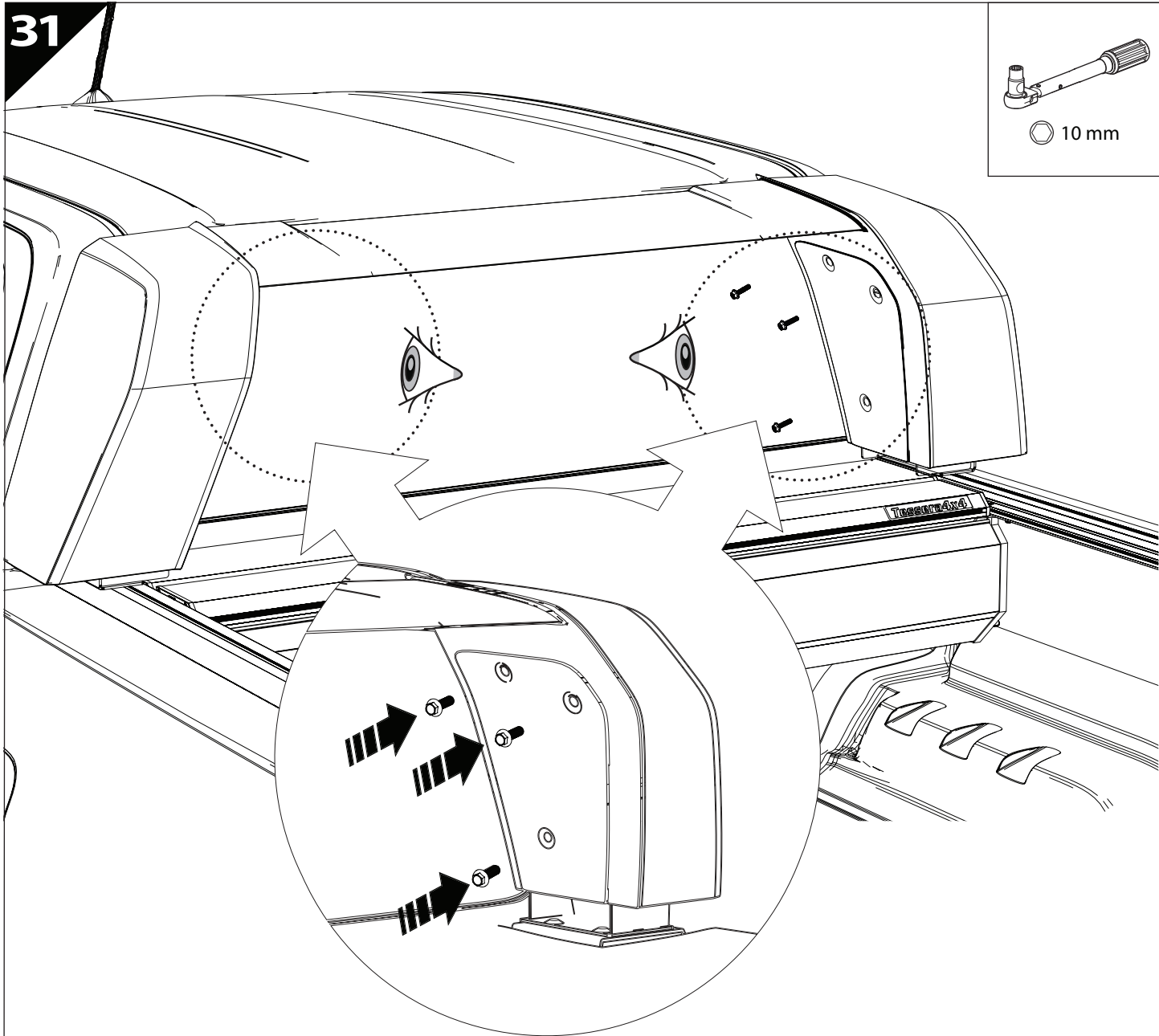

USE FROM STEP 7



32

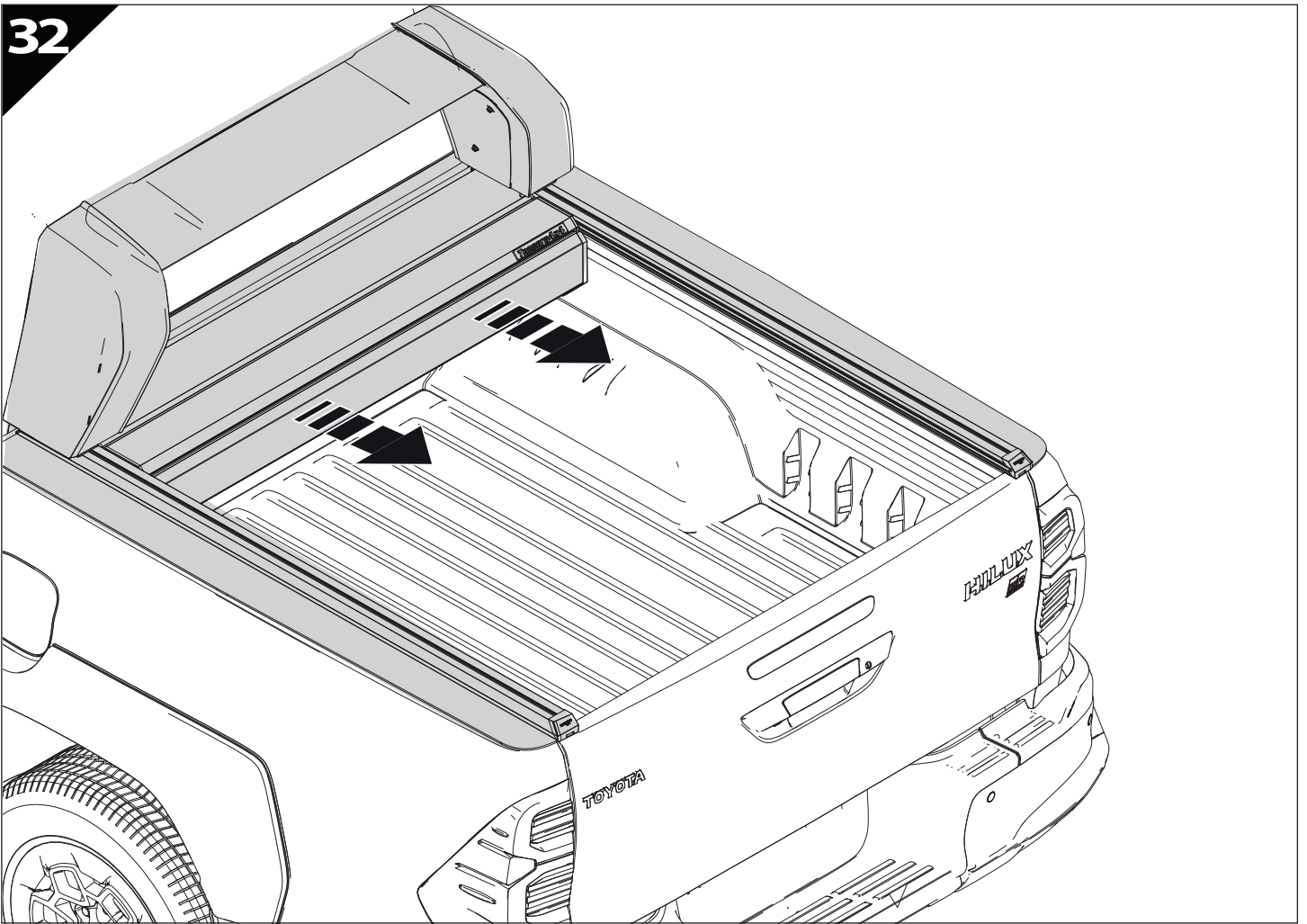

33

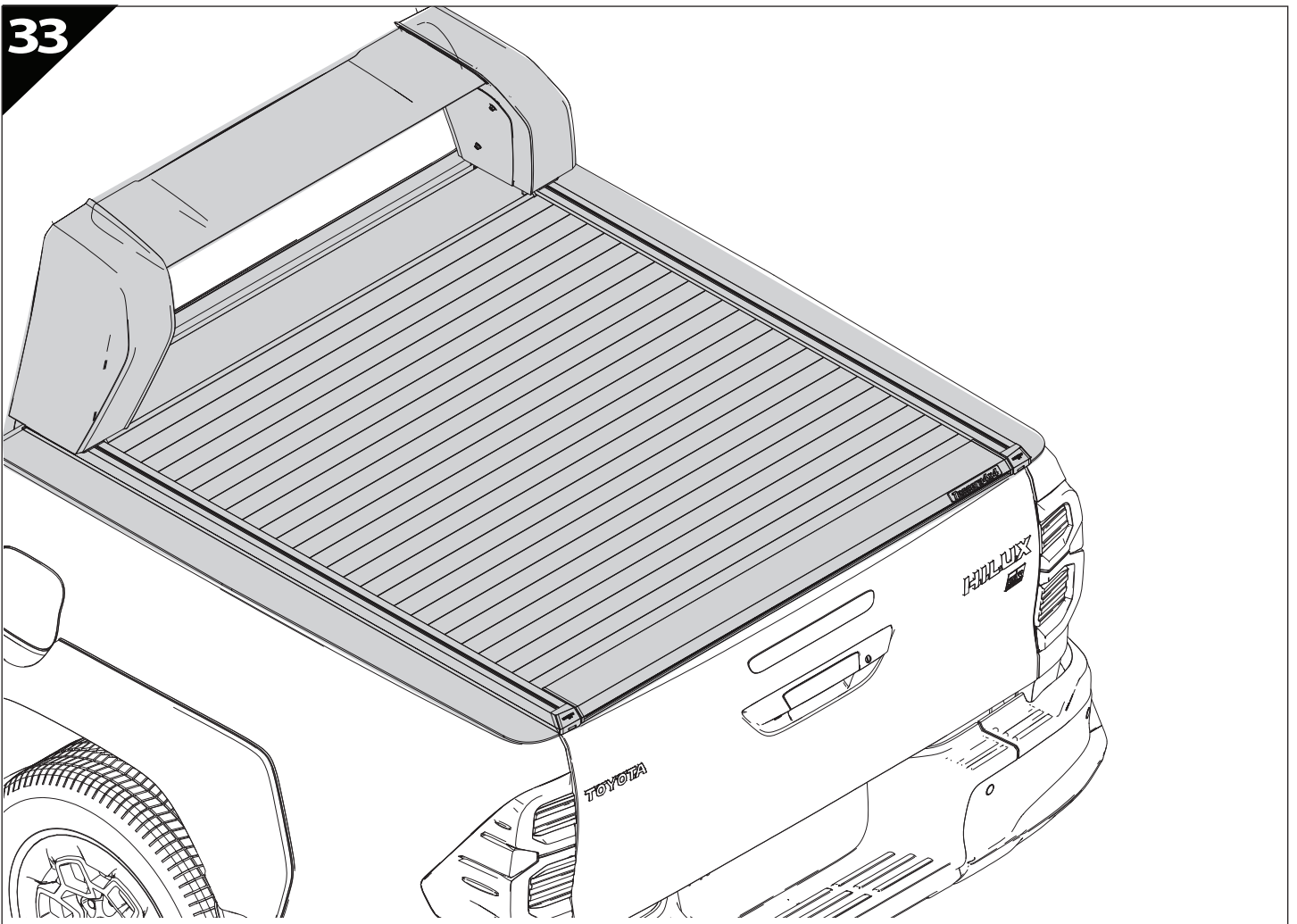







**GR:** Οδηγίες Εγκατάστασης  
**GB:** Installation manual  
**SF:** Asennusohje  
**F:** Notice de montage  
**PL:** Instrukcja montażu  
**NL:** Installatie-instructies  
**TR:** Montaj Talimatı  
**S:** Monteringsanvisning  
**E:** Instrucciones de montaje

**H:** Szerelési utasítás  
**P:** Instruções de instalação  
**RUS:** Инструкция по установке  
**N:** Monteringsveiledning  
**D:** Einbauanleitung  
**CZ:** Návod k instalaci  
**I:** Istruzioni de montaggio  
**DK:** Monteringsvejledning  
**RO:** Instructiuni de instalare

Customer Service:

+30 (210) 5541161, +30 (210) 5541154 (08:00 - 16:00 EET)

Support department:

[info@gianso.gr](mailto:info@gianso.gr)

Website:

[www.tessera4x4.com](http://www.tessera4x4.com)

Address:

19.5 km of National road Athens-Korinthos (Elefsina) Greece, P.C: 19200